

Double Union Full Port Ball Valve
WCB ■ CF8M ■ Various other Alloys
3000 PSI (1/4" - 2")



**GLOBAL VALVE
& CONTROLS**



SERIES 790

Providing Hundreds of Products. Supporting Thousands of Clients. Controlling Millions of Gallons.

DEPEND ON US. WE CAN HANDLE THE PRESSURE.



SERIES G



GF-3



CKF-2



SERIES CK



GLF-4



SERIES GL



NVG6000



NV10000



GLOBAL VALVE
& CONTROLS

Control > Quality
Flow >



20-RP



20-FP



SERIES SBG



SERIES EXPG



SERIES FS



BV2000



CFS



SERIES 2T/3T



BV3600



BV6000

BV3705



SERIES 30



YFS w/ MCB



FS525



SERIES 790



SERIES 10



SERIES 800



SERIES FSD-61

Discover the difference!



Series 790

- ◆ Sizes 1/4"-2"
- ◆ 3000 W.O.G. (PSI)
- ◆ 5-Piece Body Design, Full Port
- ◆ Threaded End Connections to ASME B1.20.1 (NPT)
- ◆ Socket Weld Connections to ASME B16.11
- ◆ Carbon or Stainless Steel
- ◆ Rugged Vinyl Coated SS Handle
- ◆ NACE MR0175 Compliant
- ◆ Standard TFM seats and seals



GLOBAL Valve & Controls®  is an ISO 9001 certified and API 6D, Q1 licensed valve manufacturer of Domestic and Non Domestic products. Offering Ball, Globe, Gate, Expanding Gate, Slab Gate, Check, and Needle Valves; Actuators and Automation Accessories.

 accommodates & services the Upstream, Midstream & Down-stream market segments of the oil/gas industry, with a primary focus on Natural Gas Transport and Storage Projects, as well as, the Petrochemical, Agricultural, Mining, Water/ Waste Management, and Aerospace Industrial Sectors.

GLOBAL Valve & Controls® has the right valve for the right application, ranging from ANSI 150 through 2500, sizes 1/4 to 48", in Stainless Steel, Carbon Steel, Alloy 20, Monel, Duplex, and other various exotic body materials.

 also carries fully automated valve packages, fugitive emission solutions, control packages, cryogenic valves, as well as, various valve coating solutions. Special Ordering is available!

GLOBAL Valve & Controls® continues to make strides in elevating our company beyond industry standards, by being consistent in providing products that are of superior quality and performance, dedicating ourselves to quality assurance, and being immediately responsive to our customer needs. We look forward to the opportunity to supply your valve needs!

Sincerely



Troy Richard
CEO at GLOBAL Valve
& Controls



MATERIALS OF CONSTRUCTION

SERIES 790

Exploded View

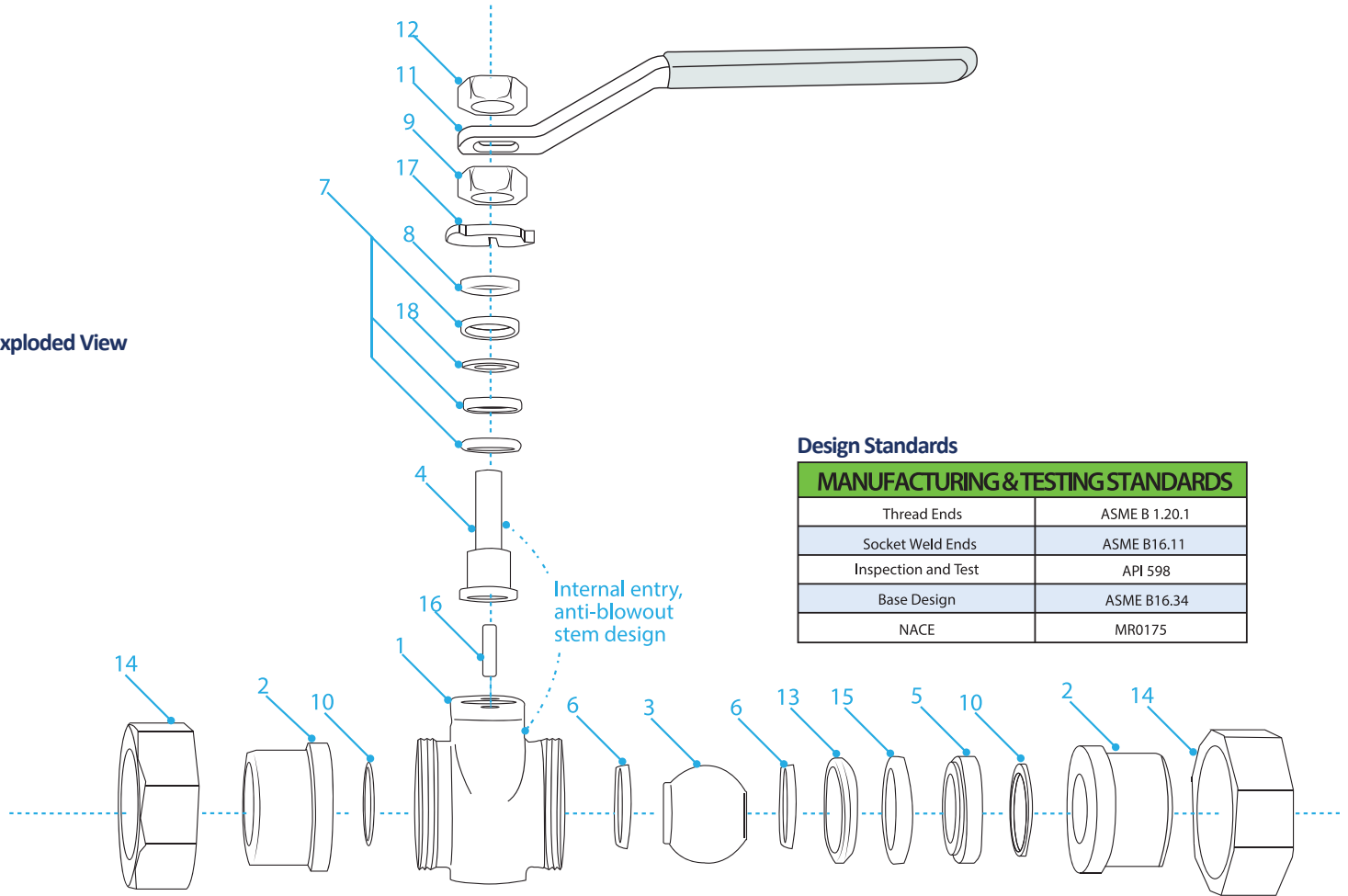

Design Standards

MANUFACTURING & TESTING STANDARDS	
Thread Ends	ASME B 1.20.1
Socket Weld Ends	ASME B16.11
Inspection and Test	API 598
Base Design	ASME B16.34
NACE	MR0175

Bill of Materials

NO.	PART NAME	MATERIALS	
1	Body	Carbon Steel, WCB	316 Stainless Steel, CF8M
2	Union End	Carbon Steel, WCB	316 Stainless Steel, CF8M
3	Ball	316 Stainless Steel	
4	Stem	316 Stainless Steel	
5	Threaded Spacer	Carbon Steel	316 Stainless Steel
6	Seats	TFM	
7	Stem Seal Set	TFM	
8	Gland Ring	Carbon Steel	304 Stainless Steel
9	Adjusting Nut	Carbon Steel	
10	Body Seal End Seal	TFE, Buna, Viton, TFM	
11	Handle	1/4" to 2" Carbon Steel Plastic Coated	
12	Stem Nut	Carbon Steel	
13	Seat Locket	Carbon Steel	316 Stainless Steel
14	Union Nut	A105 Carbon Steel	
15	Spacer Seal	TFE	
16	Stop Pin	Carbon Steel	
17	Travel Stop	Carbon Steel	
18	Grounding Washer	302 Stainless Steel	

Pressure Temperature Chart

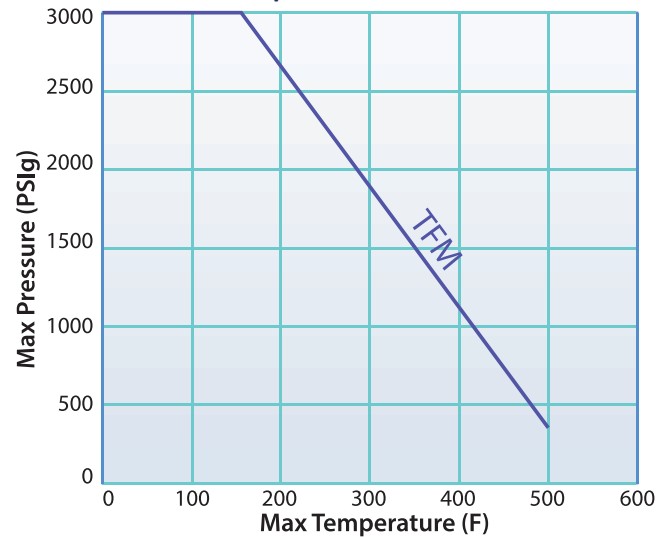

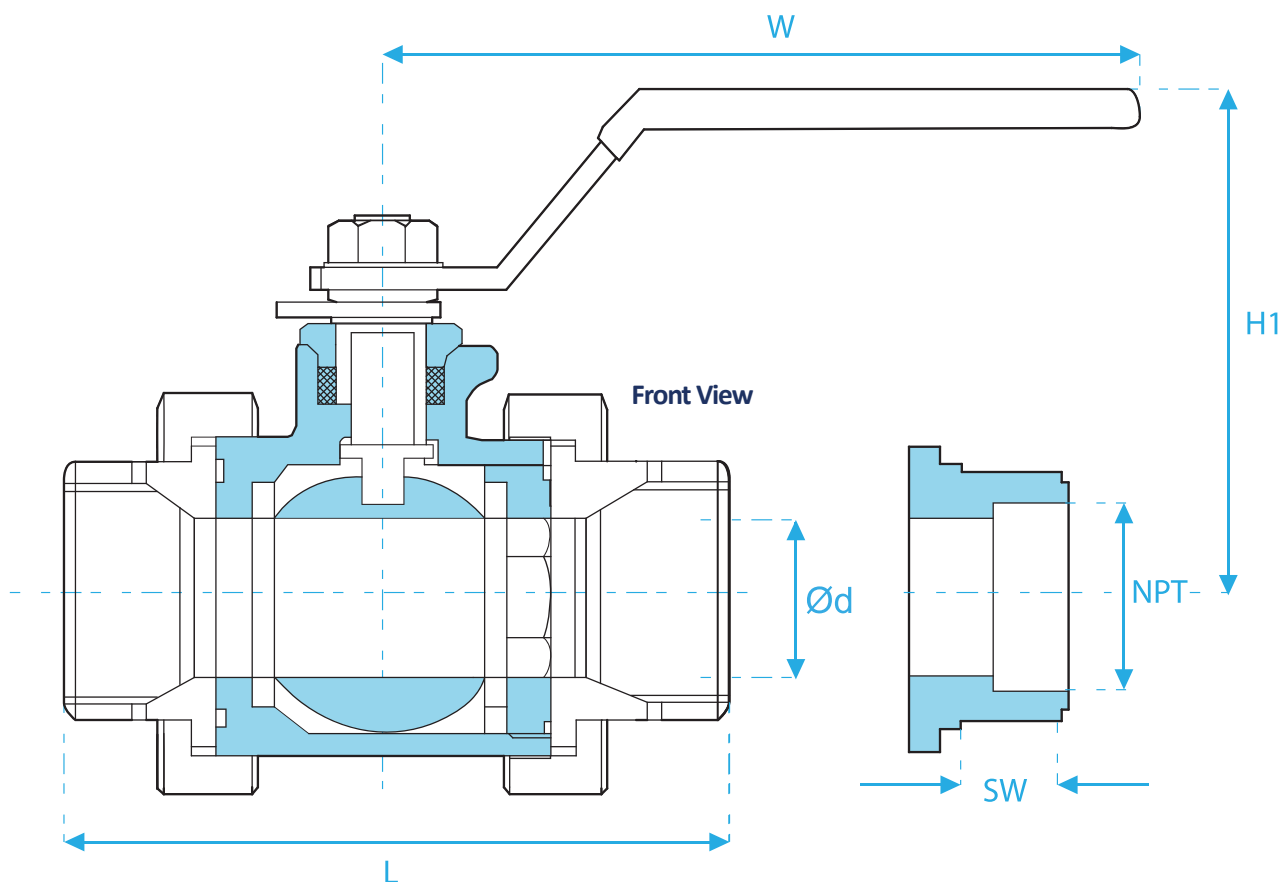

Design Standards

MANUFACTURING & TESTING STANDARDS	
Thread Ends	ASME B 1.20.1
Socket Weld Ends	ASME B16.11
Inspection and Test	API 598
Base Design	ASME B16.34
NACE	MR0175

Dimension Chart

UNIT	SIZE	L	Ød	H1	W	SW	NPT
in	1/4"	3.543	0.437	2.402	4.134	---	0.540
mm	8	90	11	61	105	---	14
in	3/8"	3.543	0.437	2.402	4.134	---	0.675
mm	10	90	11	61	105	---	17
in	1/2"	3.543	0.622	2.402	4.134	0.440	0.840
mm	15	90	16	61	105	11	21
in	3/4"	3.701	0.807	2.756	4.941	0.560	1.050
mm	20	94	20	70	126	14	27
in	1"	4.252	1.000	2.913	6.909	0.720	1.315
mm	25	108	25	74	175	18	33
in	1 1/4"	4.567	1.250	3.228	7.805	0.720	1.660
mm	32	116	32	82	198	18	42
in	1 1/2"	5.197	1.500	3.504	9.783	0.720	1.900
mm	40	132	38	89	248	18	48
in	2"	5.669	1.969	3.819	9.783	0.840	2.375
mm	50	144	50	97	248	21	60



HOW TO ORDER

SERIES 790



SERIES 790

- ◆ Sizes 1/4" – 2" 3000 W.O.G (PSI) Rated
- ◆ 5-Piece Design
- ◆ Full Port
- ◆ NACE MR0175 Compliant
- ◆ Blowout proof stem design

Series	Body	Trim	Seats	Seals	Ends	Operator	Options	Size
790	1 - Carbon Steel	3 - 316SS	H-TFM	H-TFM	TE - Threaded Ends	L - Lever Handle	O2 - Oxygen Service	1/4"
		X - Special	R- Reinforced Teflon	R- Reinforced Teflon				3/8"
	3 - 316SS				SW - Socket Weld		X - Special	1/2"
								3/4"
	X - Special		T- Teflon (TFE)	T- Teflon (TFE)				1"
				G - Grafoil				1 1/4"
								1 1/2"
								2"

790	3	3	H	H	TE		-.50
Series	Body	Trim	Seats	Seals	Ends	Options	Size

Description:

1/2" 3000 PSI Rated, 5-Piece Design, Full Port, Threaded End Ball Valve, 316SS Body, F316 Stainless Steel Trim, TFM Seats & Seals, NACE MR0175 Complaint with Lever Handle.

PLEASE NOTE: There may be some performance variations between the GVC Series 790 and other manufacturer's comparable body designs. To ensure the longevity of performance, please provide specific information relevant to the requirements needed for each application process.



8535 Jackrabbit Rd., Ste i
Houston, TX 77095
866.965.8GVC (482)
281.463.1474 office
281.463.7735 fax
www.GVCINTL.com

Please contact our sales representatives to receive more information regarding your systems particular needs.

Due to the ongoing development of our product line, Global Valve & Controls reserves the right to change the dimensions contained in the leaflet, as required.