

Three Piece Full Port Ball Valve
WCB ■ CF8M ■ Various other Alloys
1000 PSI (1/4" - 4")



SERIES 30



**GLOBAL VALVE
& CONTROLS**



Providing Hundreds of Products. Supporting Thousands of Clients. Controlling Millions of Gallons.

DEPEND ON US. WE CAN HANDLE THE PRESSURE.



SERIES G



GF-3



CKF-2



SERIES CK



GLF-4



SERIES GL



NVG6000



NV10000



**GLOBAL VALVE
& CONTROLS**

Control > Quality
Flow >



20-RP



20-FP



SERIES SBG



SERIES EXPG



SERIES FS



BV2000



CFS



SERIES 2T/3T



BV3600



BV6000

BV3705



SERIES 30



SERIES 790



SERIES 10



SERIES 800



SERIES FSD-61



YFS w/ MCB



FS525

Discover the difference!



Series 30

- ◆ Sizes 1/4" - 4"
- ◆ 1000 W.O.G. (PSI)
- ◆ 3-Piece Body Design, Full Port
- ◆ Threaded End Connections to ASME B1.20.1 (NPT)
- ◆ Socket Weld Connections to ASME B16.11
- ◆ Carbon or Stainless Steel
- ◆ Blowout Proof Stem
- ◆ NACE MR0175 Compliant
- ◆ Adjustable Stem Packing
- ◆ Locking SS handle
- ◆ In-line replaceable
- ◆ High-Quality Investment Casting



GLOBAL Valve & Controls®  is an ISO 9001 certified and API 6D, Q1 licensed valve manufacturer of Domestic and Non Domestic products. Offering Ball, Globe, Gate, Expanding Gate, Slab Gate, Check, and Needle Valves; Actuators and Automation Accessories.

 accommodates & services the Upstream, Midstream & Down-stream market segments of the oil/gas industry, with a primary focus on Natural Gas Transport and Storage Projects, as well as, the Petrochemical, Agricultural, Mining, Water/ Waste Management, and Aerospace Industrial Sectors.

GLOBAL Valve & Controls® has the right valve for the right application, ranging from ANSI 150 through 2500, sizes 1/4 to 48", in Stainless Steel, Carbon Steel, Alloy 20, Monel, Duplex, and other various exotic body materials.

 also carries fully automated valve packages, fugitive emission solutions, control packages, cryogenic valves, as well as, various valve coating solutions. Special Ordering is available!

GLOBAL Valve & Controls® continues to make strides in elevating our company beyond industry standards, by being consistent in providing products that are of superior quality and performance, dedicating ourselves to quality assurance, and being immediately responsive to our customer needs. We look forward to the opportunity to supply your valve needs!

Sincerely



Troy Richard
CEO at GLOBAL Valve
& Controls



MATERIALS OF CONSTRUCTION

SERIES 30

Exploded Angle View

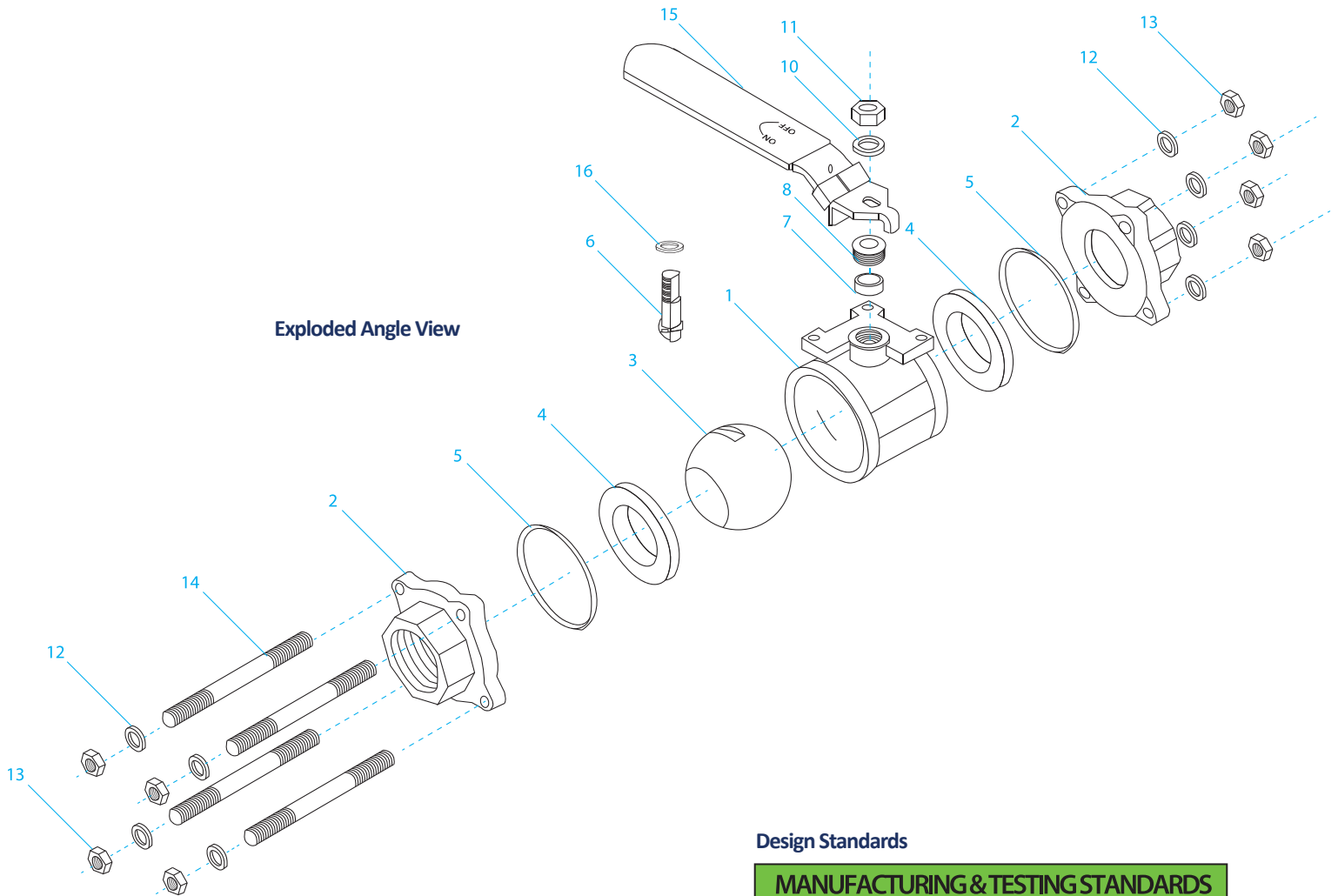

Bill of Materials

NO.	PART NAME	MATERIAL	
1	Body	A351-CF8M	A216-WCB
2	Valve End (threaded shown)	A351-CF8M	A216-WCB
3	Ball	316SS	
4	Seat	Reinforced Teflon/TFM/Teflon	
5	Valve Body Gasket	Reinforced Teflon/TFM/Teflon	
6	Stem	A276-316	
7	Gland Packing	PTFE®/RTFE/TFM	
8	Gland	304SS	
9	Handle (standard shown)	304SS	
10	Stem Washer	316SS	
11	Stem Nut	304SS	
12	Bolt Washer	316SS	
13	Nut	316SS	
14	Bolt	316SS	
15	Handle Cover	Plastic	
16	Thrust Bearing	PTFE® or RTFE	

Design Standards

MANUFACTURING & TESTING STANDARDS	
Thread Ends	ASME B 1.20.1
Socket Weld Ends	ASME B16.11
Inspection and Test	API 598
Base Design	ASME B16.34
NACE	MR0175

Pressure Temperature Chart

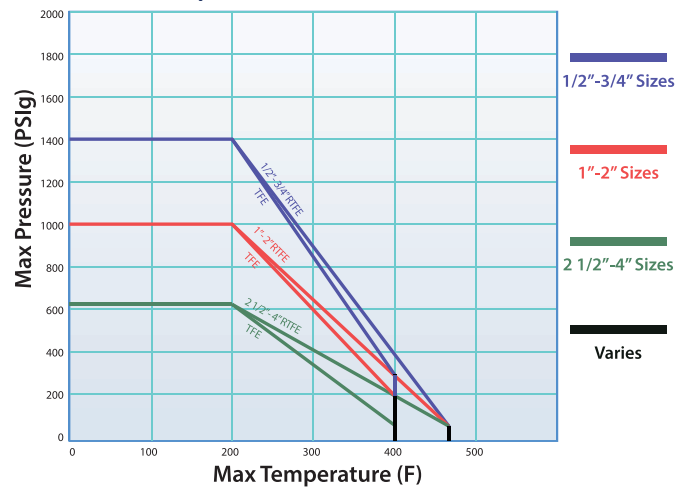



MATERIALS AND ENGINEERING DATA

SERIES 30

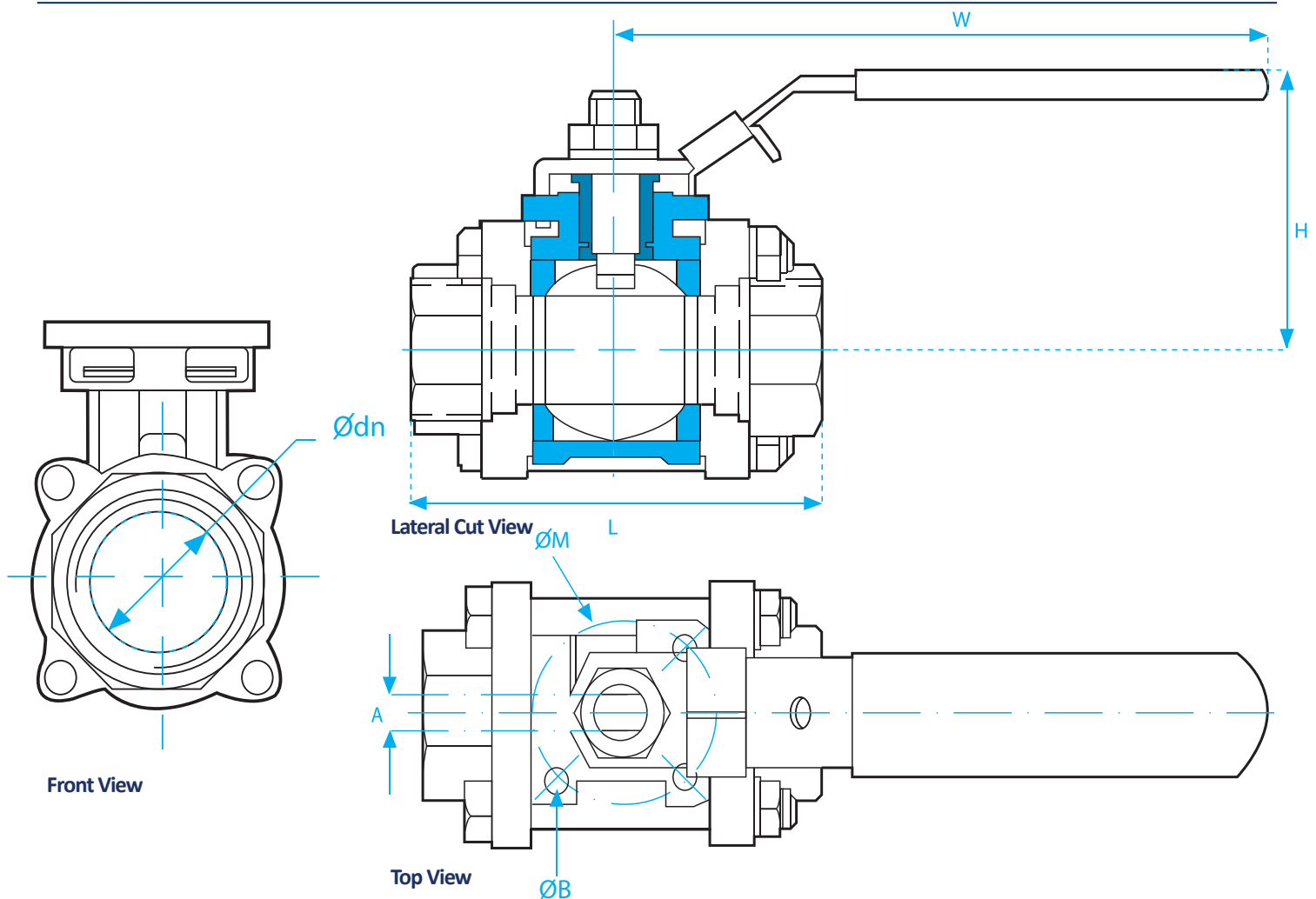

Key

NO.	PART NAME
L	LENGTH (END TO END)
A	DISTANCE FROM FLAT TO FLAT ON STEM
W	DIAMETER OF HANDWHEEL/ LENGTH OF LEVER
H	HEIGHT (CENTER OF BORE TO TOP OF VALVE)
Ødn	DIAMETER OF BORE
ØM	DIAMETER THAT MOUNTING PAD BOLTHOLES ARE CENTERED ON
ØB	DIAMETER OF BOLTHOLES ON MOUNTING PAD

CV Chart

SIZE	CV FACTOR	TORQUE	WEIGHT
1/4"	13	17-43	0.93
3/8"	24	17-52	0.91
1/2"	35	17-87	1.42
3/4"	63	26-104	1.75
1"	96	43-113	3.13
1 1/4"	129	52-130	5.03
1 1/2"	205	87-217	6.55
2"	465	130-303	9.75
2 1/2"	834	156-346	17.38
3"	1097	173-390	29.68
4"	1960	260-606	53.95

*CV = GPM results in a 1 psi pressure drop

Dimension Chart

UNIT	SIZE	Ødn	L	H	W	ØM	ØB	A
in	1/4"	0.457	2.520	2.008	4.055	1.417	M5	0.197
mm	8	12	64	51	103	36	M5	5
in	3/8"	0.500	2.520	2.008	4.055	1.417	M5	0.197
mm	10	13	64	51	103	36	M5	5
in	1/2"	0.591	2.827	2.126	4.055	1.417	M5	0.197
mm	15	15	72	54	103	36	M5	5
in	3/4"	0.787	3.339	2.244	4.921	1.654	M5	0.256
mm	20	20	85	57	125	42	M5	7
in	1"	1.000	3.587	2.598	5.709	1.654	M5	0.315
mm	25	25	91	66	145	42	M5	8
in	1 1/4"	1.260	4.331	2.835	5.709	1.654	M5	0.315
mm	32	32	110	72	145	42	M5	8
in	1 1/2"	1.496	4.831	3.209	7.480	1.969	M6	0.382
mm	40	38	123	82	190	50	M6	10
in	2"	2.000	5.579	3.563	7.480	1.969	M6	0.382
mm	50	51	142	91	190	50	M6	10
in	2 1/2"	2.559	6.843	5.453	9.843	2.756	M8	0.472
mm	65	65	174	139	250	70	M8	12
in	3"	2.992	7.587	5.866	9.843	2.756	M8	0.472
mm	80	76	193	149	250	70	M8	12
in	4"	3.937	10.791	6.949	11.339	3.543	M10	0.591
mm	100	100	274	177	288	90	M10	15

Design Standards

MANUFACTURING & TESTING STANDARDS	
Thread Ends	ASME B 1.20.1
Socket Weld Ends	ASME B16.11
Inspection and Test	API 598
Base Design	ASME B16.34
NACE	MR0175



HOW TO ORDER

SERIES 30



SERIES 30

- ◆ Sizes 1/4" – 4" 1000 W.O.G. (PSI) Rated
- ◆ 3-Piece Body Design
- ◆ Full Port
- ◆ Blowout Proof Stem Design
- ◆ NACE MR0175 Compliant

Series	Body	Trim	Seats	Seals	Ends	Operator	Options	Size
30	1 - Carbon Steel	3 - 316SS	H - TFM	G - Grafoil	SW - Socket Weld	L - Lever Handle	X - Special	1/4"
		X - Special	R- Reinforced Teflon	H - TFM				3/8"
	3 - 316SS				TE - Threaded Ends			1/2"
				R- Reinforced Teflon				3/4"
	X - Special		T- Teflon (TFE)					1"
								1 1/4"
				T- Teflon (TFE)				1 1/2"
								2"
								2 1/2"
								3"
								4"

30	1	3	T	T	TE		-01
Series	Body	Trim	Seats	Seals	Ends	Options	Size

Description:

1", 1000 WOG Three Piece Full Port Threaded Ball Valve, Carbon Steel Body and 316SS Trim, TFE Seats and Seals, NACE MR0175 Compliant w/ Locking Lever Handle

PLEASE NOTE: There may be some performance variations between the GVC Series 30 and other manufacturer's comparable body designs. To ensure the longevity of performance, please provide specific information relevant to the requirements needed for each application process.



8535 Jackrabbit Rd., Ste i
Houston, TX 77095
866.965.8GVC (482)
281.463.1474 office
281.463.7735 fax
www.GVCINTL.com

Please contact our sales representatives to receive more information regarding your systems particular needs.

Due to the ongoing development of our product line, Global Valve & Controls reserves the right to change the dimensions contained in the leaflet, as required.