

Full Port and Reduced Port Ball Valve
WCB ■ CF8M ■ Various other Alloys
2000 PSI (1/4" - 2")



**GLOBAL VALVE
& CONTROLS**



SERIES 20-RP

Providing Hundreds of Products. Supporting Thousands of Clients. Controlling Millions of Gallons.

DEPEND ON US. WE CAN HANDLE THE PRESSURE.



SERIES G



GF-3



CKF-2



SERIES CK



GLF-4



SERIES GL



NVG6000



NV10000



GLOBAL VALVE
& CONTROLS

Control > Quality
Flow >



20-RP



20-FP



SERIES SBG



SERIES EXPG



SERIES FS



BV2000



CFS



SERIES 2T/3T



BV3600



BV6000



BV3705



SERIES 30



SERIES 790



SERIES 10



SERIES 800



SERIES FSD-61



YFS w/ MCB



FS525

Discover the difference!



Series 20-RP

- ◆ Sizes 1/4"-2", 2000 W.O.G. (PSI)
- ◆ 2 Piece Body Design, Full Port (1/4-3/4) Reduced Port (1"-2")
- ◆ Threaded End Connections to ASME B1.20.1 (NPT)
- ◆ Carbon or Stainless Steel
- ◆ Blowout Proof Stem
- ◆ NACE MR0175 Compliant
- ◆ Adjustable Stem Packing
- ◆ Seat Options: TFM, NOVA and PTFE
- ◆ High-Quality Investment Casting
- ◆ Locking SS handle



GLOBAL Valve & Controls®  is an ISO 9001 certified and API 6D, Q1 licensed valve manufacturer of Domestic and Non Domestic products. Offering Ball, Globe, Gate, Expanding Gate, Slab Gate, Check, and Needle Valves; Actuators and Automation Accessories.

 accommodates & services the Upstream, Midstream & Down-stream market segments of the oil/gas industry, with a primary focus on Natural Gas Transport and Storage Projects, as well as, the Petrochemical, Agricultural, Mining, Water/ Waste Management, and Aerospace Industrial Sectors.

GLOBAL Valve & Controls® has the right valve for the right application, ranging from ANSI 150 through 2500, sizes 1/4 to 48", in Stainless Steel, Carbon Steel, Alloy 20, Monel, Duplex, and other various exotic body materials.

 also carries fully automated valve packages, fugitive emission solutions, control packages, cryogenic valves, as well as, various valve coating solutions. Special Ordering is available!

GLOBAL Valve & Controls® continues to make strides in elevating our company beyond industry standards, by being consistent in providing products that are of superior quality and performance, dedicating ourselves to quality assurance, and being immediately responsive to our customer needs. We look forward to the opportunity to supply your valve needs!

Sincerely



Troy Richard
CEO at GLOBAL Valve
& Controls



MATERIALS OF CONSTRUCTION

SERIES 20-RP

Threaded Reduced Port Ball valve

EXPLODED ANGLE VIEW

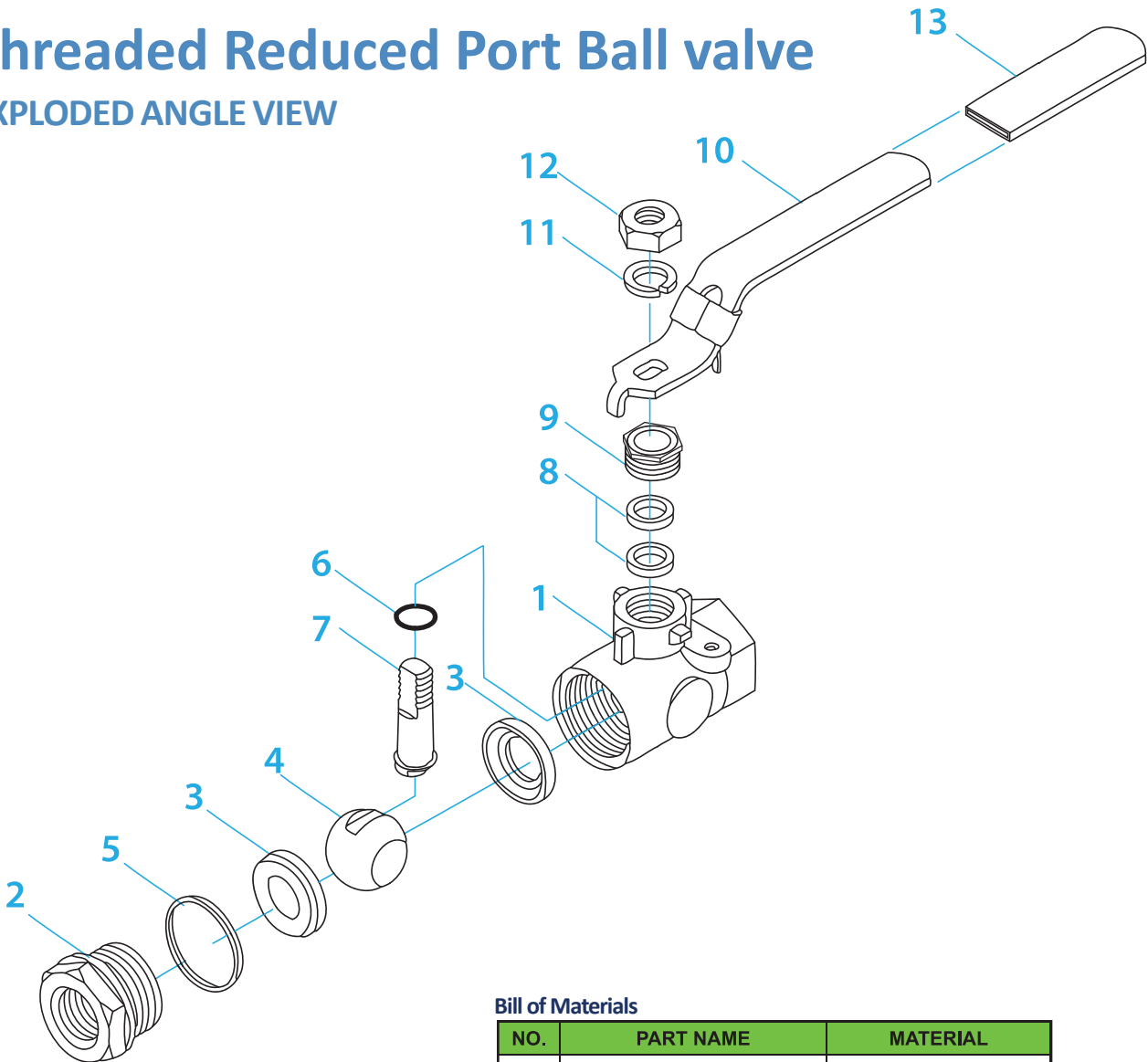

Design Standards

MANUFACTURING & TESTING STANDARDS	
Thread Ends	ASME B 1.20.1
Socket Weld Ends	ASME B16.11
Inspection and Test	API 598
Base Design	ASME B16.34
NACE	MR0175

Bill of Materials

NO.	PART NAME	MATERIAL
1	Body	A351-CF8M A216-WCB
2	End Connector	A351-CF8M A216-WCB
3	Seat	TFM/ RPTFE® or NOVA
4	Ball	316SS
5	Valve Body Gasket	PTFE® or NOVA
6	Thrust Ring	PTFE® or NOVA
7	Stem	316SS
8	Gland Packing	PTFE® or NOVA
9	Gland Nut	304SS
10	Handle (standard shown)	304SS
11	Stem Washer	304SS
12	Stem Nut	304SS
13	Handle Cover	Plastic

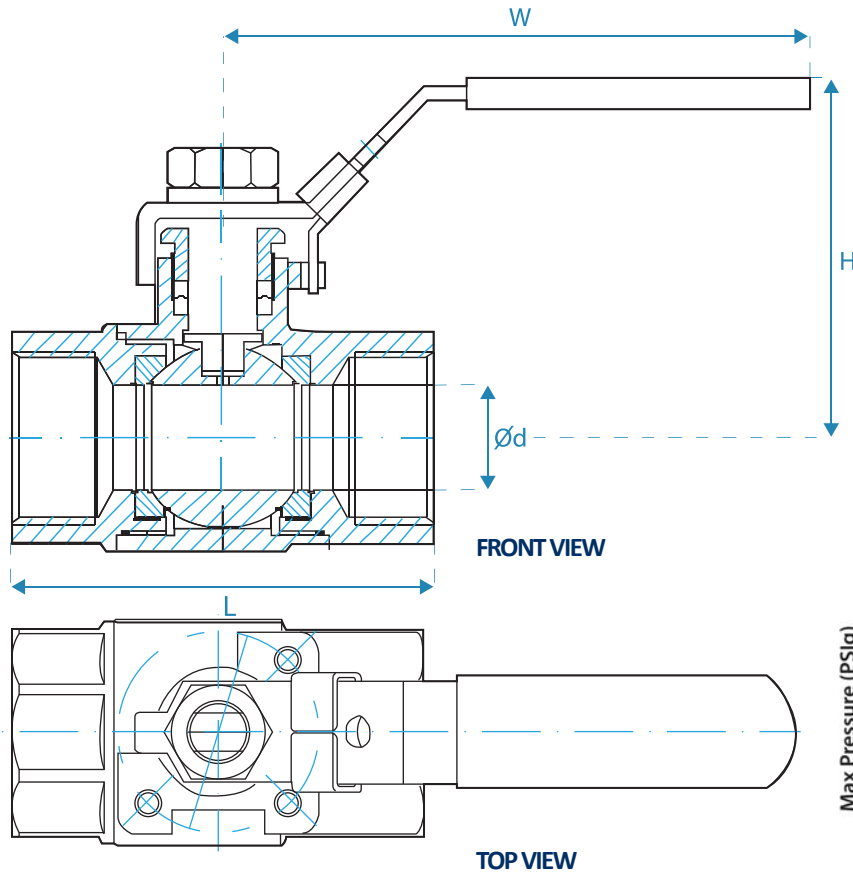

SIZE	CV FACTOR	WEIGHT
1/4"	6	1.00
3/8"	6	.89
1/2"	12	1.30
3/4"	36	1.60
1"	68	2.00
1 1/4"	98	5.00
1 1/2"	160	6.00
2"	210	8.00

*CV = GPM results in a 1 psi pressure drop

Pressure Temperature Chart

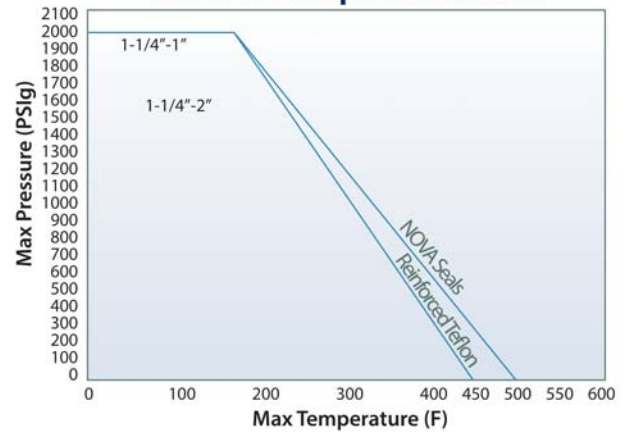

Key

NO.	PART NAME
L	LENGTH (END TO END RF ONLY)
Ød	DIAMETER OF BORE
ØM	DIAMETER THAT MOUNTING PAD BOLTHOLES ARE CENTERED ON
H	HEIGHT (CENTER OF BORE TO TOP OF VALVE)
W	DIAMETER OF HANDWHEEL/ LENGTH OF LEVER
ØB	DIAMETER OF BOLTHOLES ON MOUNTING PAD

Design Standards

MANUFACTURING & TESTING STANDARDS	
Thread Ends	ASME B 1.20.1
Socket Weld Ends	ASME B16.11
Inspection and Test	API 598
Base Design	ASME B16.34
NACE	MR0175

Dimension Chart

UNITS	SIZE	Ød	L	H	W
in	1/4"	0.44	2.24	2.06	3.94
mm	8	11	57	52	100
in	3/8"	0.47	2.24	2.06	3.94
mm	10	12	57	52	100
in	1/2"	0.50	2.31	2.06	3.94
mm	15	12.5	59	52	100
in	3/4"	0.71	3.11	2.48	4.92
mm	20	18	79	63	125
in	1"	0.80	3.39	2.63	4.92
mm	25	20	86	67	125
in	1 1/4"	0.99	3.90	2.72	6.30
mm	32	25	99	69	160
in	1 1/2"	1.30	4.10	3.19	6.30
mm	40	33	104	81	160
in	2"	1.50	5.39	3.76	7.78
mm	50	38	137	95	198



HOW TO ORDER

SERIES 20-RP



SERIES 20-RP

- ◆ 1/4" – 1" 2000 W.O.G. (PSI) Rated
- ◆ 1 1/4" – 2" 1500 W.O.G. (PSI) Rated
- ◆ 2-Piece Body Design
- ◆ Full Port (FP) (1/4"-3/4") or Reduced Port (RP) (1"-2")
- ◆ NACE MR0175 Complaint, Blow Out Proof Stem

Series	Body	Trim	Seats	Seals	Ends	Operator	Options	Size
20FP Full Port	1 - Carbon Steel	3 - 316SS	H - TFM	G - Grafoil	TE - Threaded Ends	L - Lever Handle	X - Special	1/4"
		X - Special	N - NOVA	H - TFM				3/8"
20RP Reduced Port	3 - 316SS		R - Reinforced Teflon	N - NOVA				1/2"
	X - Special		T - Teflon (TFE)	R - Reinforced Teflon				3/4"
				T - Teflon (TFE)				1"
								1 1/4"
								1 1/2"
								2"

20RP	1	3	T	T	TE		-01
Series	Body	Trim	Seats	Seals	Ends	Options	Size

Description:

1", 2000 PSI, 2-Piece Body Design, Reduced Port, Carbon Steel Body, F316 Stainless Steel Trim, Teflon Seats & Seals Threaded Ends, with Locking Handle, NACE MR0175 Compliant, Fire-Safe Design

PLEASE NOTE: There may be some performance variations between the GVC Series 20-RP and other manufacturer's comparable body designs. To ensure the longevity of performance, please provide specific information relevant to the requirements needed for each application process.



8535 Jackrabbit Rd., Ste i
Houston, TX 77095
866.965.8GVC (482)
281.463.1474 office
281.463.7735 fax
www.GVCINTL.com

Please contact our sales representatives to receive more information regarding your systems particular needs.

Due to the ongoing development of our product line, Global Valve & Controls reserves the right to change the dimensions contained in the leaflet, as required.