

API 6D Expanding/ Slab Gate Valves
WCC ■ WCB ■ CF8M ■ Various other Alloys
ANSI 150-300-600-900-1500 (2" - 36")



**GLOBAL VALVE
& CONTROLS**



SERIES SBG/ EXPG

Providing Hundreds of Products. Supporting Thousands of Clients. Controlling Millions of Gallons.

DEPEND ON US. WE CAN HANDLE THE PRESSURE.



SERIES G



GF-3



SERIESCK



GLF-4



SERIESGL



CKF-2



NVG6000



NV10000



™



20-RP



20-FP

GLOBAL VALVE & CONTROLS



SERIES SBG



SERIES EXPG



SERIES FS



BV2000



SERIES 2T/3T



BV3600



BV6000



CFS



SERIES 30



BV3705



YFS w/ MCB



FS525



SERIES 790



SERIES 10



SERIES 800



SERIES FSD-61

Discover the difference!



Series EXPG

- ◆ Sizes 2" - 36"
- ◆ ANSI Class 300-1500
- ◆ API 6D **Expanding** Gate
- ◆ Full Port, Through Conduit
- ◆ Live Loaded Stem Packing
- ◆ Available in A216 WCB, WCC, Stainless Steel and Other Various Materials
- ◆ Butt Weld, Raised Face, and Ring Type Joint (RTJ)
- ◆ NACE MR0175 Compliant
- ◆ B16.10
- ◆ B16.5
- ◆ B16.34
- ◆ Valve forms Positive Tight Sealing
- ◆ Seals at Low & High Pressure



Series SBG

- ◆ Sizes 2" - 36"
- ◆ ANSI Class 150-1500
- ◆ API 6D **Slab** Gate Valve
- ◆ Full Port, Through Conduit
- ◆ Live Loaded Stem Packing
- ◆ Available in A216 WCB, WCC, Stainless Steel and Other Various Materials
- ◆ Butt Weld, Raised Face, and Ring Type Joint (RTJ)
- ◆ NACE MR0175 Compliant
- ◆ B16.10
- ◆ B16.5
- ◆ B16.34
- ◆ Internal Pressure Relieving

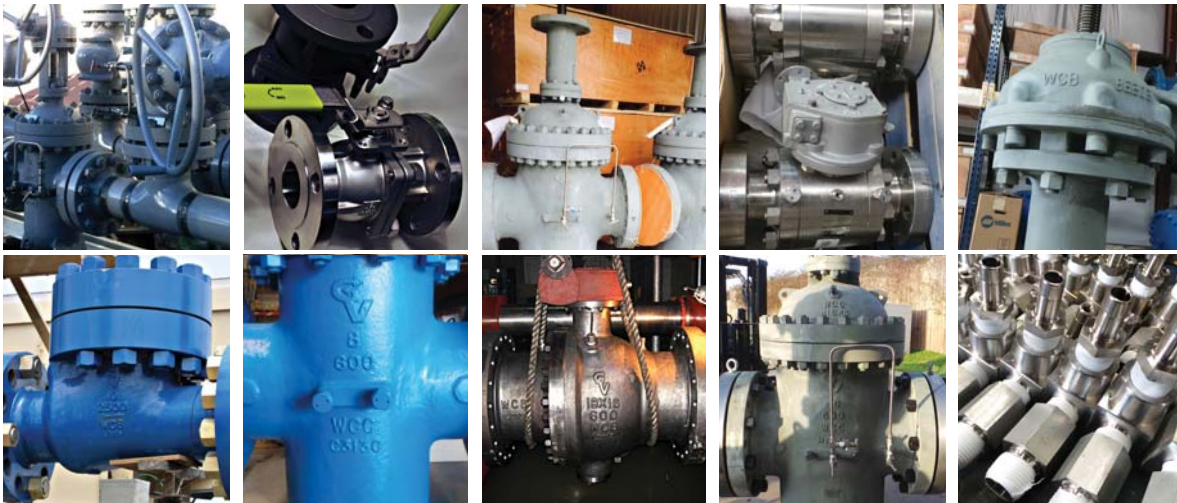

GLOBAL Valve & Controls®  is an ISO 9001 certified and API 6D, Q1 licensed valve manufacturer of Domestic and Non Domestic products. Offering Ball, Globe, Gate, Expanding Gate, Slab Gate, Check, and Needle Valves; Actuators and Automation Accessories.

 accommodates & services the Upstream, Midstream & Down-stream market segments of the oil/gas industry, with a primary focus on Natural Gas Transport and Storage Projects, as well as, the Petrochemical, Agricultural, Mining, Water/ Waste Management, and Aerospace Industrial Sectors.

GLOBAL Valve & Controls® has the right valve for the right application, ranging from ANSI 150 through 2500, sizes 1/4 to 48", in Stainless Steel, Carbon Steel, Alloy 20, Monel, Duplex, and other various exotic body materials.

 also carries fully automated valve packages, fugitive emission solutions, control packages, cryogenic valves, as well as, various valve coating solutions. Special Ordering is available!

GLOBAL Valve & Controls® continues to make strides in elevating our company beyond industry standards, by being consistent in providing products that are of superior quality and performance, dedicating ourselves to quality assurance, and being immediately responsive to our customer needs. We look forward to the opportunity to supply your valve needs!

Sincerely



Troy Richard
CEO at GLOBAL Valve
& Controls

TABLE OF CONTENTS

SERIES EXPG / SBG

TABLE OF CONTENTS

Specifications/Product Review..... 5

Series EXPG

Series Expanding Gate Section View..... 6-7

Gearbox 8

Handwheel..... 9

Working Diagram..... 10

Series SBG

Series Slab Gate Section View..... 11-12

Gearbox 13

Handwheel..... 14

Working Diagram..... 15

Series EXPG/SBG

Engineering Data Dimensions 16-20

CV Value 21

Pressure Temperature Ratings 22-24

Flange Dimensions 25-26

How to Order Series SBG 27

How to Order Series EXPG 28

GVC THRU CONDUIT SLAB GATE

- Pressure assisted seats for high pressure sealing
- Spring loaded seat for low pressure sealing
- Double block and bleed capabilities
- Internal pressure relieving through self relieving seats
- Secondary sealant injection at seats and stems
- Full port thru conduit for passage of pigs

GVC THRU CONDUIT EXPANDING GATE

- Expanding mechanical gate forms positive tight sealing
- Seals at low and high pressure
- Double block and bleed capabilities
- Secondary sealant injections at seats and stem
- Optional by-pass system for thermal cavity relief venting
- Full port thru conduit for passage of pigs
- Live loaded packing design for low fugitive emissions. (optional)

BASIC DESIGN

API 6D

FACE TO FACE DIMENSION

ANSI B16.10

FLANGE END DIMENSION

ANSI B16.5 (2" to 24")

ANSI B16.47 & MSS SP-44 (26" & up)

BUTT-WELD END DIMENSION

ANSI B16.25

INSPECTION & TESTING

API 6D

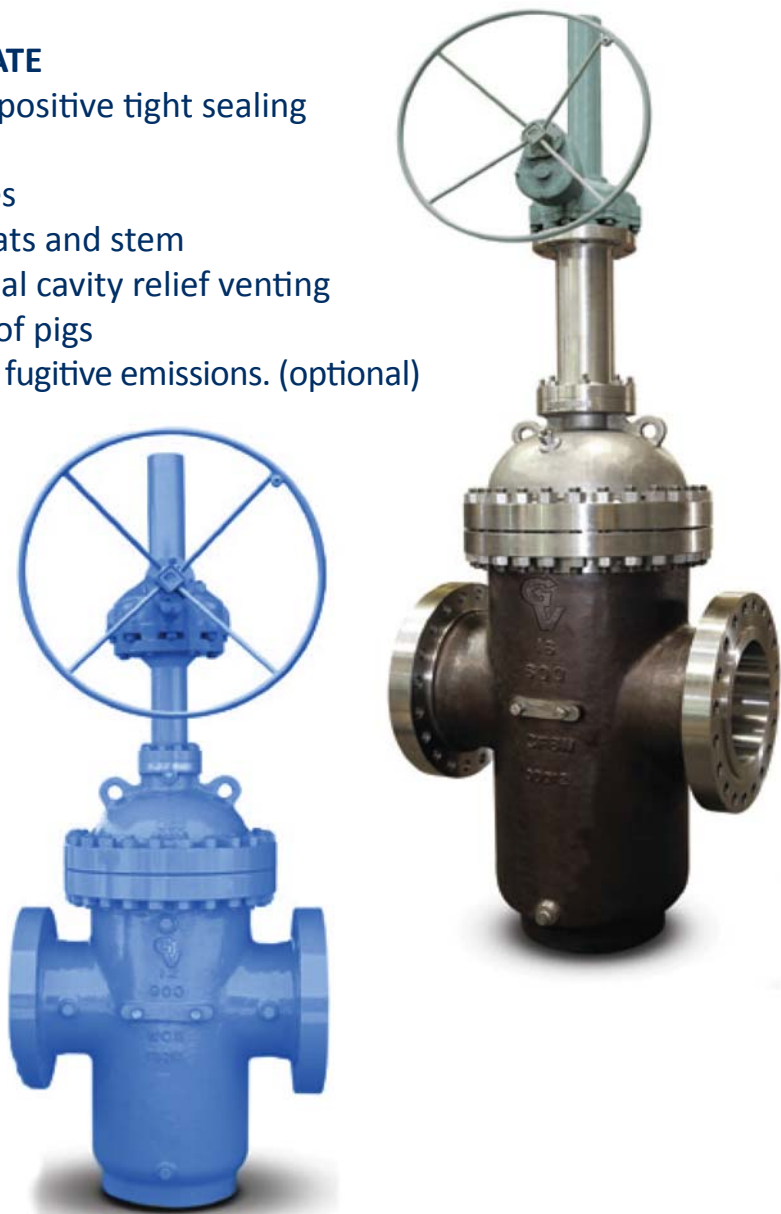

Note: Not recommended for throttling applications.

Note: GVC reserves the right to change any technical design and dimensional data without prior notice. Please contact GVC to confirm all Dimensions and Data offered in this catalog.

THE EXPANDING GATE VALVE

THE EXPANDING GATE VALVE

THE EXPANDING GATE

SERIES EXPG

THE EXPANDING GATE

- Expanding mechanical gate forms positive tight sealing
- Seals at low and high pressure
- Double block and bleed capabilities
- Secondary sealant injections at seats and stem
- Optional by-pass system for thermal cavity relief venting
- Full port thru conduit for passage of pigs
- Live loaded packing design for low fugitive emissions. (optional)

EXPANDING GATE SECTION VIEW

SERIES EXPG

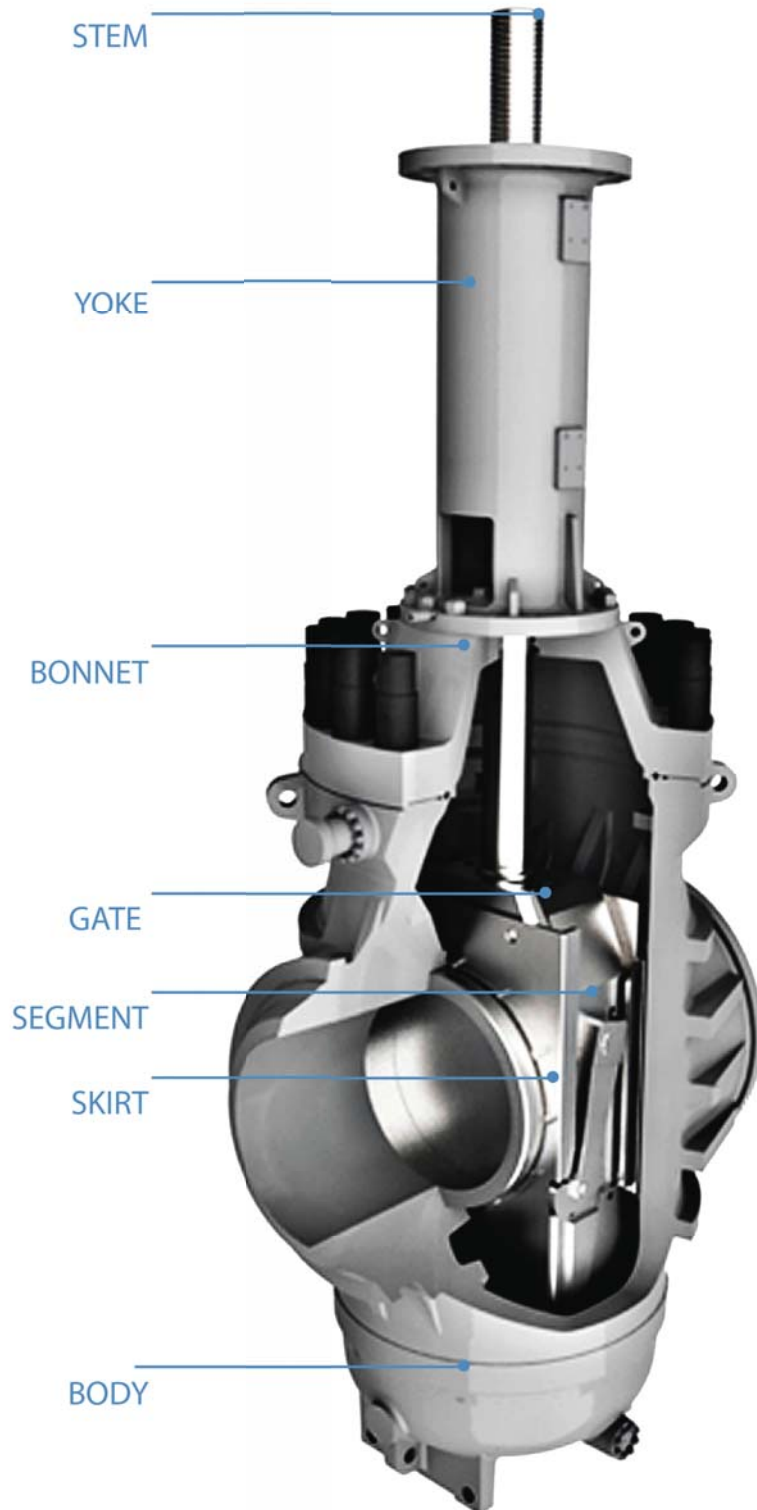



EXPANDING GATE ENGINEERING DATA

SERIES EXPG WITH GEARBOX

BILL OF MATERIALS		
NO.	PART	MATERIAL
1	BODY	ASTM A216 WCC/WCB
2	BONNET	ASTM A216 WCC/WCB
3	YOKE (2" to 8")	ASTM A216 WCC/WCB
3a	YOKE (10")	ASTM A216 WCC/WCB
4	STEM	ASTM 4130+ENP / SS 17-4PH
5	GATE	ASTM A105+ENP
6	SEGMENT W/ STOPPER	ASTM A105+ENP
7	SEAT RETAINER	ASTM A105+ENP
8	SEAT O-RING	VITON / HNBR
9	SEAT INSERT	VITON / NYLON
10	SKIRT	A576 1025 + Zn
11	BONNET GASKET	304 SS+ GRAPHITE
12	STUD	ASTM A193 B7M
13	NUT	ASTM A194 2HM
14	PACKING THRUST WASHER	PTFE / RPTFE
15	LANTERN RING	A276 410
16	PACKING RINGS	PTFE/ RPTFE
17	PACKING GLAND	A276 410
18	GLAND FLANGE	ASTM A216 WCC/WCB
19	STUD	ASTM A193 B7M
20	NUT	ASTM A194 2HM
21	STUD	ASTM A193 B7M
22	NUT	ASTM A194 2HM
23	NUT	ASTM A194 2HM
24	STEM INDICATOR	Q235A+ HCr
25	BEVEL GEAR	ASTM A216 - WCB
26	STEM PROTECTOR	Q235A / LEXAN
27	VIEWING DOOR	Q235 + Zn
28	SCREW	A576 1025+Zn
29	INJECTION FITTING	4140 / F316
30	DRAIN FITTING	4140 / F316
31	NAMEPLATE	A240 304
32	LEVER LOCK	A576 1045
33	LEVER LOCK SCREW	ASTM A193 B7M
34	NUT	ASTM A194 2HM
35	ELASTIC WASHER	65MN
36	STUD	ASTM A193 B7M
37	THERMAL RELIEF	316 SS
38	BELLVILLE WASHERS*	INCONEL X-750
39	VENT FITTING	4140 / F316

LEGEND	
MEANING	SYMBOL
PART OPTIONAL	*
PART CALLOUT	_____
GUIDE LINE	-----

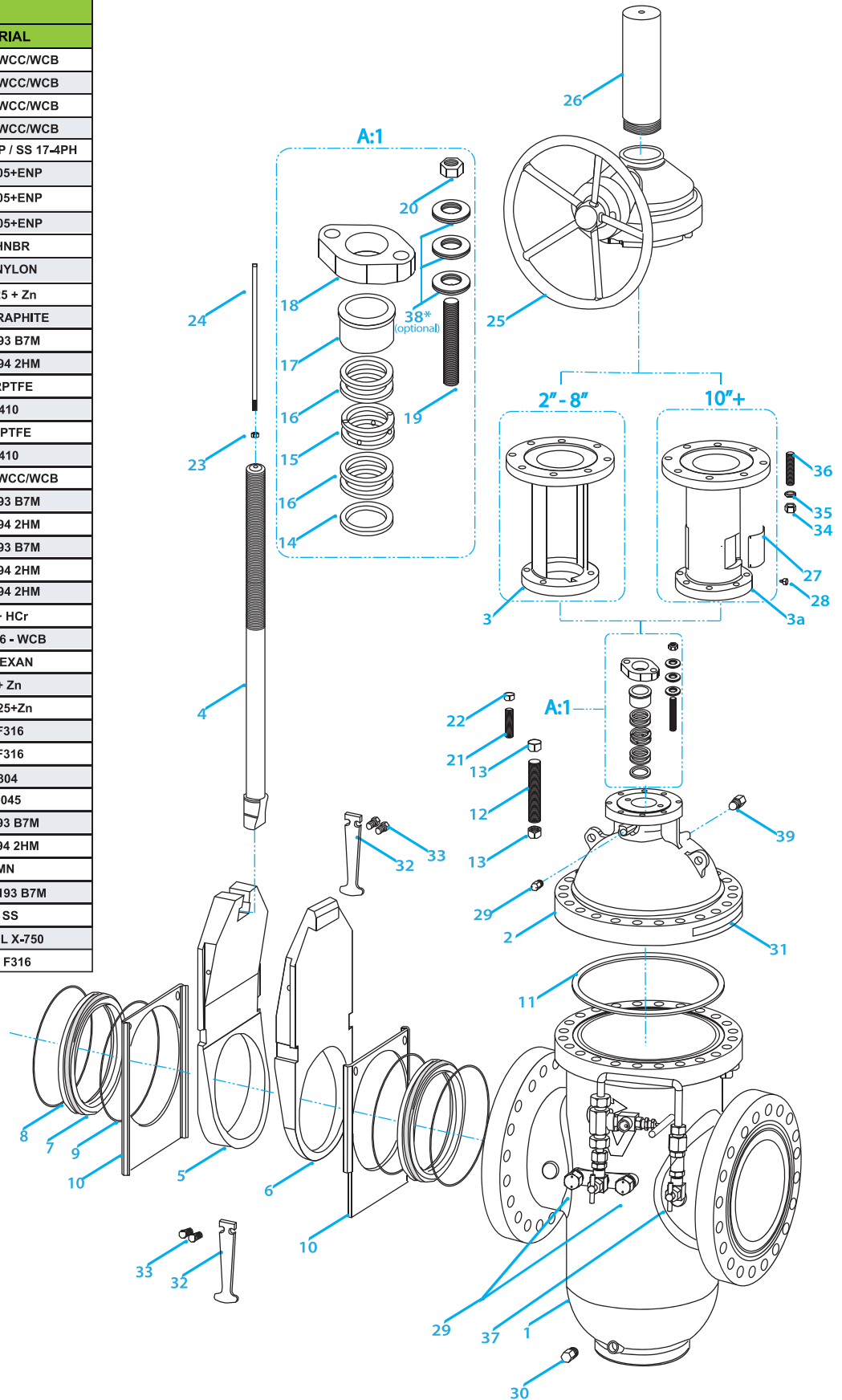

*All dimensions are for reference only, please consult sales office prior to automation due to ongoing product development.

Due to the ongoing development of our product line, Global Valve & Controls reserves the right to change the dimensions contained in the leaflet, as required.
Series EXPG/ SBG



EXPANDING GATE ENGINEERING DATA

SERIES EXPG WITH HANDWHEEL

BILL OF MATERIALS		
NO.	PART	MATERIAL
1	BODY	ASTM A216 WCC/WCB
2	BONNET	ASTM A216 WCC/WCB
3	YOKE	ASTM A216 WCC/WCB
4	STEM	ASTM 4130+ENP / SS 17-4PH
5	GATE	ASTM A105+ENP
6	SEGMENT W/ STOPPER	ASTM A105+ENP
7	SEAT RETAINER	ASTM A105+ENP
8	SEAT O-RING	VITON / HNBR
9	SEAT INSERT	VITON / NYLON
10	SKIRT	A576 1025 + Zn
11	BONNET GASKET	304 SS + GRAPHITE
12	STUD	ASTM A193 B7M
13	NUT	ASTM A194 2HM
14	PACKING THRUST WASHER	PTFE/ RPTFE
15	LANTERN RING	A276 410
16	PACKING RINGS	PTFE/ RPTFE
17	PACKING GLAND	A276 410
18	GLAND FLANGE	ASTM A216 WCC/WCB
19	STUD	ASTM A193 B7M
20	NUT	ASTM A194 2HM
21	STUD	ASTM A193 B7M
22	NUT	ASTM A194 2HM
23	NUT	ASTM A194 2HM
24	STEM INDICATOR	Q235A + HCr
25	HANDWHEEL	ASTM A216 - WCB
26	STEM PROTECTOR	Q235A / LEXAN
27	STEM NUT	BRONZE
28	BEARING	/
29	NAMEPLATE	A240 304
30	VENT FITTING	4140 / F316
31	THERMAL RELIEF	316 SS
32	INJECTION FITTING	4140 / F316
33	DRAIN FITTING	4140 / F316
34	HANDWHEEL NUT	ASTM A216 - WCB
35	BELLVILLE WASHERS	INCONEL X-750
36	LEVER LOCK	A576 1045
37	LEVER LOCK SCREW	ASTM A193 B7M
38	STEM NUT RETAINER	A576 1025
39	INJECTION FITTING	4140 / F316

LEGEND	
MEANING	SYMBOL
PART OPTIONAL	*
PART CALLOUT	_____
GUIDE LINE	-----

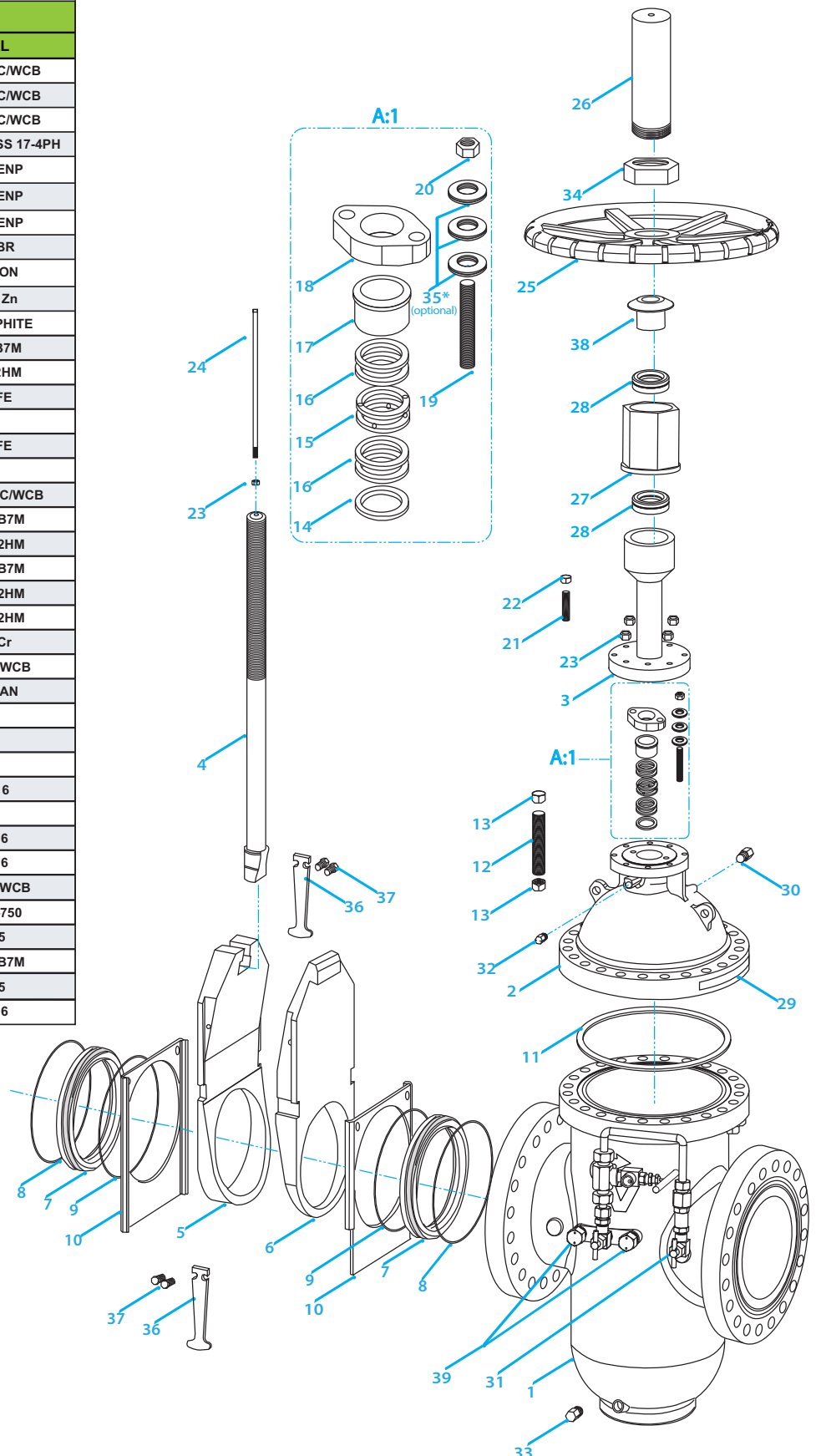

*All dimensions are for reference only, please consult sales office prior to automation due to ongoing product development.

Due to the ongoing development of our product line, Global Valve & Controls reserves the right to change the dimensions contained in the leaflet, as required.



EXPANDING GATE ENGINEERING DATA

SERIES EXPG WORKING DIAGRAMS

Expanding Gate Advanced Mechanical Details

Global Valve & Controls® Expanding Gate Valve design provides a mechanical seal between the seats and the gate in both high and low pressure applications. Our expanding gate valve does not require line pressure to seal and is recommended when a tight mechanical seal is required.

Full Expanded Closed

In the full expanded closed position, the segment stop has engaged with the lower body stop and the gate is wedged downward, expanding the gate and segment to form a tight seal against the upstream and downstream seats. Body cavity venting will assist to provide tight shut off. (Figure 1)

Figure 1
Fully Closed

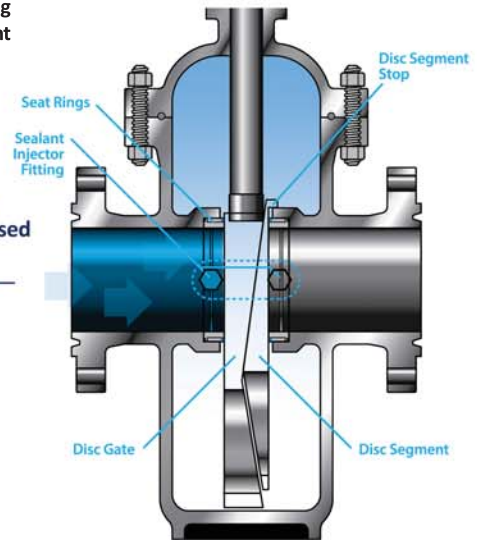

Mid Position

When operating towards the open position, the gate travels across the wedge angle of the segment. This retracts the assembly so that it will slide freely between the seat faces. (Figure 2)

Figure 2
Mid Position

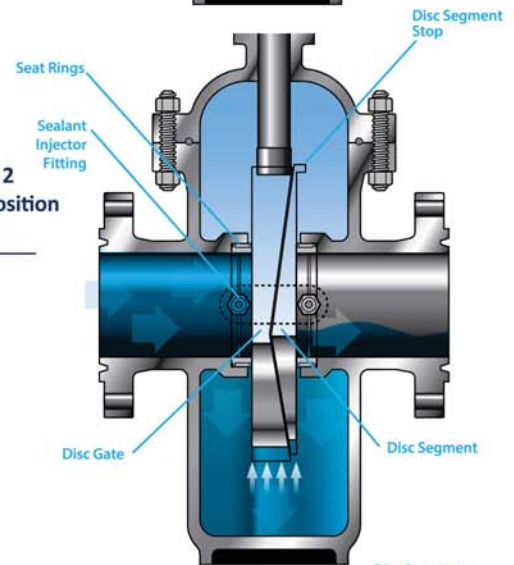

Full Expanded Open

In the full expanded open position, the segment stop has engaged the upper body stop and the gate is wedged upward. This expands the segment and the gate into the seats, isolating the flow from the cavity. (Figure 3)

Figure 3
Fully Open

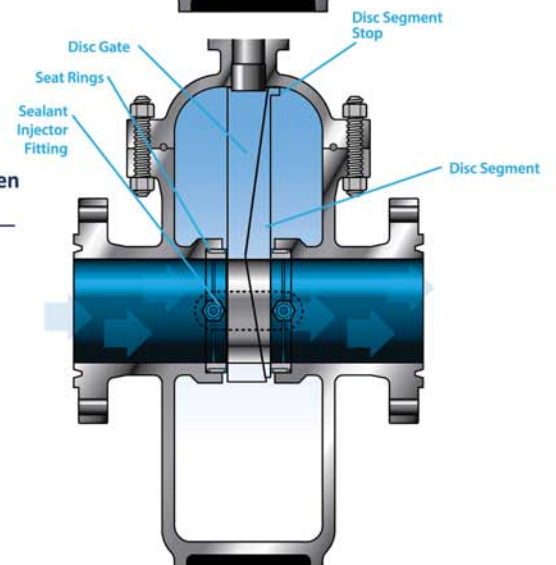

**All dimensions are for reference only, please consult sales office prior to automation due to ongoing product development.*

Due to the ongoing development of our product line, Global Valve & Controls reserves the right to change the dimensions contained in the leaflet, as required.

THE SLAB GATE VALVE

SERIES SBG

- Pressure assisted seats for high pressure sealing
- Spring loaded seat for low pressure sealing
- Double block and bleed capabilities
- Internal pressure relieving through self relieving seats
- Secondary sealant injection at seats and stems
- Full port thru conduit for passage of pigs

**All dimensions are for reference only, please consult sales office prior to automation due to ongoing product development.*

Due to the ongoing development of our product line, Global Valve & Controls reserves the right to change the dimensions contained in the leaflet, as required.

Series EXPG/ SBG

JULY 2015 REV. 0



SLAB GATE SECTION VIEW

SERIES SBG

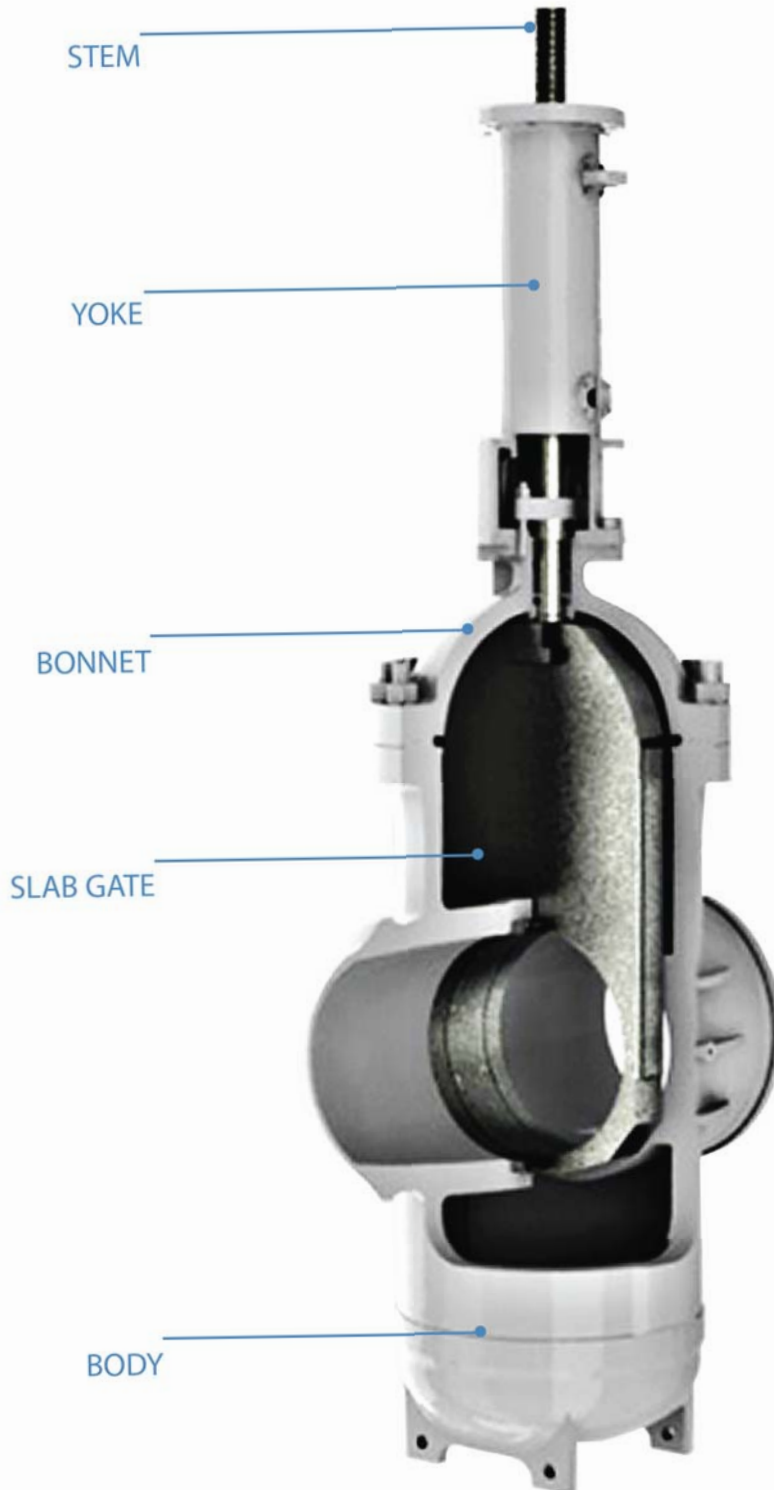

**All dimensions are for reference only, please consult sales office prior to automation due to ongoing product development.*

Due to the ongoing development of our product line, Global Valve & Controls reserves the right to change the dimensions contained in the leaflet, as required.

Series EXPG/ SBG

JULY 2015 REV. 0



SLAB GATE ENGINEERING DATA

SERIES SBG WITH GEARBOX

BILL OF MATERIALS		
NO.	PART	MATERIAL
1	BODY	ASTM A216 WCC/WCB
2	BONNET	ASTM A216 WCC/WCB
3	YOKE (2" TO 8")	ASTM A216 WCC/WCB
3a	YOKE (10"+)	ASTM A216 WCC/WCB
4	STEM	ASTM 4130+ENP / SS 17-4PH
5	SLAB GATE	ASTM A105+ENP
6	STUD	ASTM A193 B7M
7	SEAT RETAINER	ASTM A105+ENP
8	SEAT O-RING	VITON / HNBR
9	SEAT INSERT	VITON / NYLON
10	SKIRT	A576 1025+Zn
11	BONNET GASKET	304 SS + GRAPHITE
12	STUD	ASTM A193 B7M
13	NUT	ASTM A194 2HM
14	PACKING THRUST WASHER	PTFE / RPTFE
15	LANTERN RING	A276 410
16	PACKING RINGS	PTFE / RPTFE
17	PACKING GLAND	A276 410
18	GLAND FLANGE	ASTM A216 WCC/WCB
19	STUD	ASTM A193 B7M
20	NUT	ASTM A194 2HM
21	STUD	ASTM A193 B7M
22	NUT	ASTM A194 2HM
23	NUT	ASTM A194 2HM
24	STEM INDICATOR	Q235A + HCr
25	BEVEL GEAR	ASTM A216 - WCB
26	STEM PROTECTOR	Q235A / LEXAN
27	VIEWING DOOR	ASTM A216 WCC/WCB
28	SCREW	A576 1025+Zn
29	INJECTION FITTING	4140 / F316
30	DRAIN FITTING	4140 / F316
31	ELASTIC WASHER	65MN
32	NUT	ASTM A194 2HM
33	NAMEPLATE	A240 304
34	VENT FITTING	4140 / F316
35	BELLVILLE WASHERS*	INCONEL X-750
36	SEAT SPRINGS	INCONEL X-750
37	INJECTION FITTING	4140 / F316

LEGEND	
MEANING	SYMBOL
PART OPTIONAL	*
PART CALLOUT	—
GUIDE LINE	- - - - -

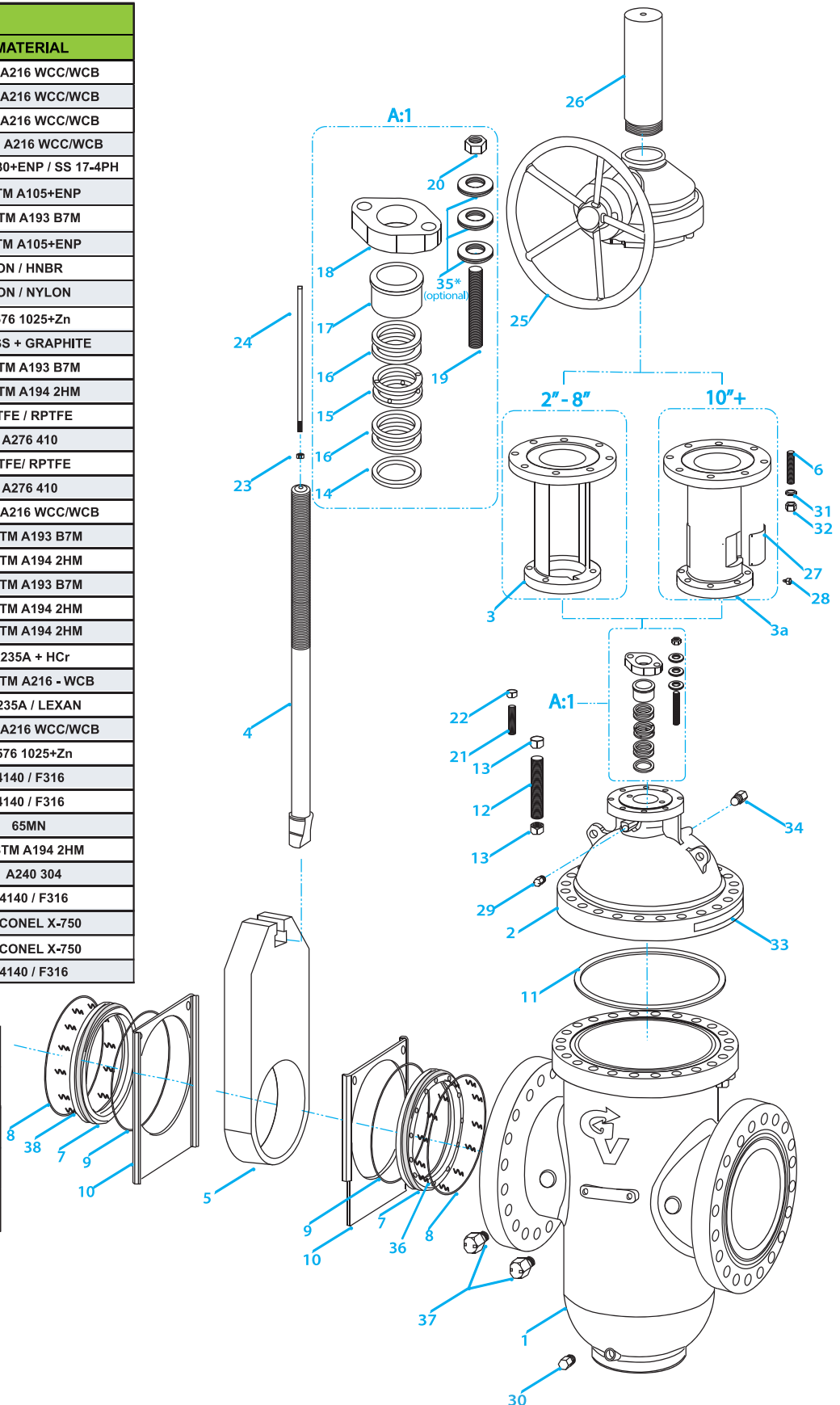

*All dimensions are for reference only, please consult sales office prior to automation due to ongoing product development.

Due to the ongoing development of our product line, Global Valve & Controls reserves the right to change the dimensions contained in the leaflet, as required.



SLAB GATE ENGINEERING DATA

SERIES SBG WITH HANDWHEEL

BILL OF MATERIALS		
NO.	PART	MATERIAL
1	BODY	ASTM A216 WCC/WCB
2	BONNET	ASTM A216 WCC/WCB
3	YOKE	ASTM A216 WCC/WCB
4	STEM	ASTM 4130+ENP / SS 17-4PH
5	HANDWHEEL NUT	A216 - WCB
6	SLAB GATE	ASTM A105+ENP
7	SEAT RETAINER	ASTM A105+ENP
8	SEAT O-RING	VITON / HNBR
9	SEAT INSERT	VITON / NYLON
10	SKIRT	A576 1025 + Zn
11	BONNET GASKET	304 SS + GRAPHITE
12	STUD	ASTM A193 B7M
13	NUT	ASTM A194 2HM
14	PACKING THRUST WASHER	PTFE / RPTFE
15	LANTERN RING	A276 410
16	PACKING RINGS	PTFE/ RPTFE
17	PACKING GLAND	A276 410
18	GLAND FLANGE	ASTM A216 WCC/WCB
19	STUD	ASTM A193 B7M
20	NUT	ASTM A194 2HM
21	STUD	ASTM A193 B7M
22	NUT	ASTM A194 2HM
23	NUT	ASTM A194 2HM
24	STEM INDICATOR	Q235A + HCr
25	HANDWHEEL	ASTM A216 - WCB
26	STEM PROTECTOR	Q235A / LEXAN
27	BELLVILLE WASHERS*	INCONEL X-750
28	BEARING	/
29	VENT FITTING	4140 / F316
30	STEM NUT RETAINER	A576 1025
31	INJECTION FITTING	4140 / F316
32	STEM NUT	BRONZE
33	NAMEPLATE	A240 304
34	DRAIN FITTING	4140 / F316
35	INJECTION FITTING	4140 / F316
36	SEAT SPRINGS	INCONEL X-750

LEGEND	
MEANING	SYMBOL
PART OPTIONAL	*
PART CALLOUT	—
GUIDE LINE	- - - - -

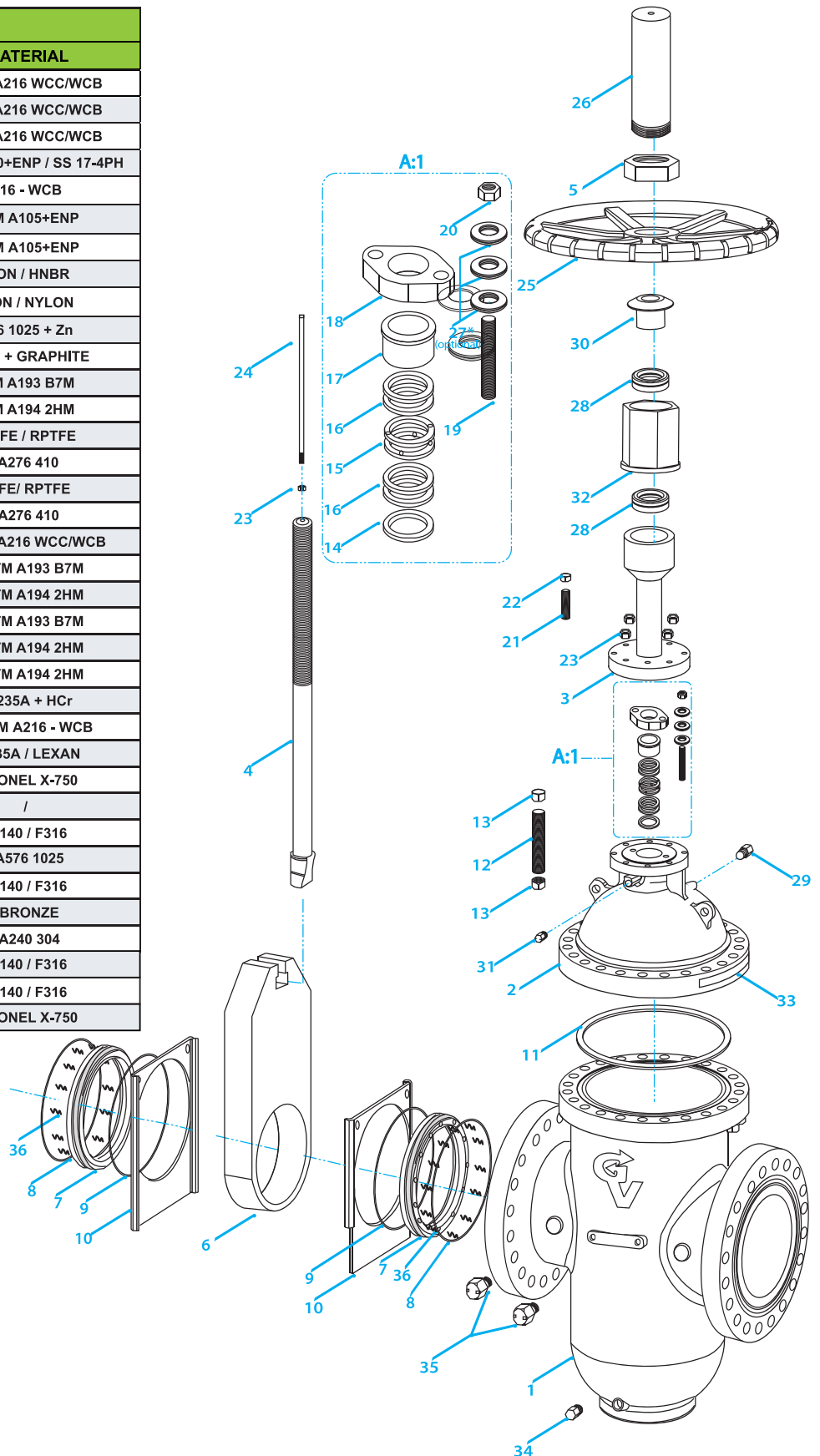

*All dimensions are for reference only, please consult sales office prior to automation due to ongoing product development.

Due to the ongoing development of our product line, Global Valve & Controls reserves the right to change the dimensions contained in the leaflet, as required.

SLAB GATE ENGINEERING DATA

SERIES SBG WORKING DIAGRAMS

Slab Gate Advanced Mechanical Details

Through its simple design and efficient performance, the slab gate's two spring loaded floating seats are pressure energized. This allows for complete sealing, both upstream and downstream.

Seats- Soft & Metal

Our spring loaded double O-ring design seats maintain a perfect seal with the gate in both low and high pressure applications. The soft seat inserts help to ensure that the primary sealing occurs at the gate. In the event of soft seat damage, the seating of metal to metal will function as a secondary seal. (Figure 1)

Figure 1

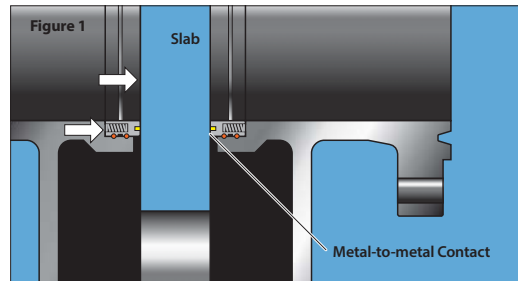

Double Block

When the valve is in the closed position and also has equal or no pressure, both spring loaded seats can shut off line pressure independently of upstream and downstream pressure. This creates a double block scenario. (Figure 2)

Figure 2

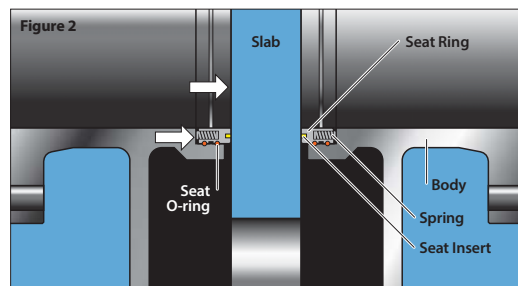

Line Pressure

When line pressure is applied, the pressure forces the slab gate to float against the downstream seat and form a tight seal. At the same time, the upstream line pressure forces the upstream seat on the slab gate to form an upstream seal. (Figure 3)

Figure 3

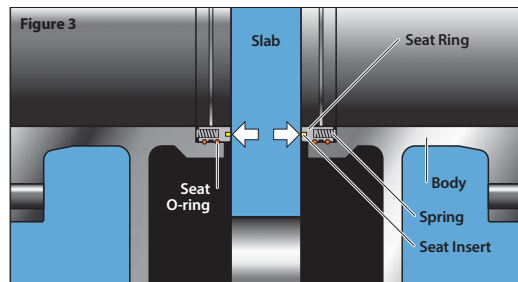

Self Relieving Cavity

The double block and bleed slab gate design, in the closed position, may experience an increase in cavity pressure due to thermal expansion. When the cavity pressure exceeds the line the excess cavity pressure to be vented into the line. This allows for a pressure balance between the body cavity and the line. (Figure 4)

Figure 4

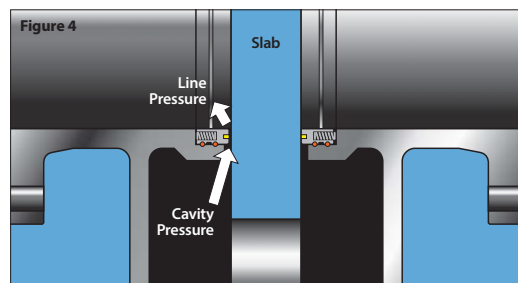

Secondary Sealant Injection System

Valves 6" and larger will have secondary sealant injection fittings for the stem and seats. If the seat inserts or stem O-rings become damaged, leakage from the seat and stem can be prevented by injecting sealant into the fittings. (Figure 5)

Figure 5

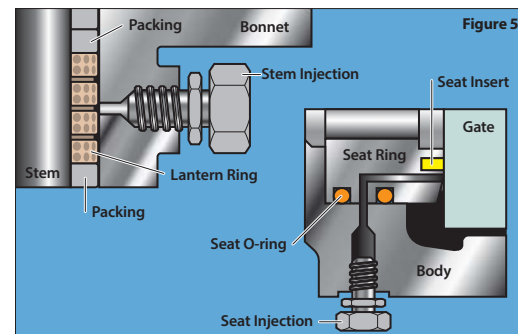

*All dimensions are for reference only, please consult sales office prior to automation due to ongoing product development.



ENGINEERING DATA

SERIES EXPG / SBG DIMENSIONS

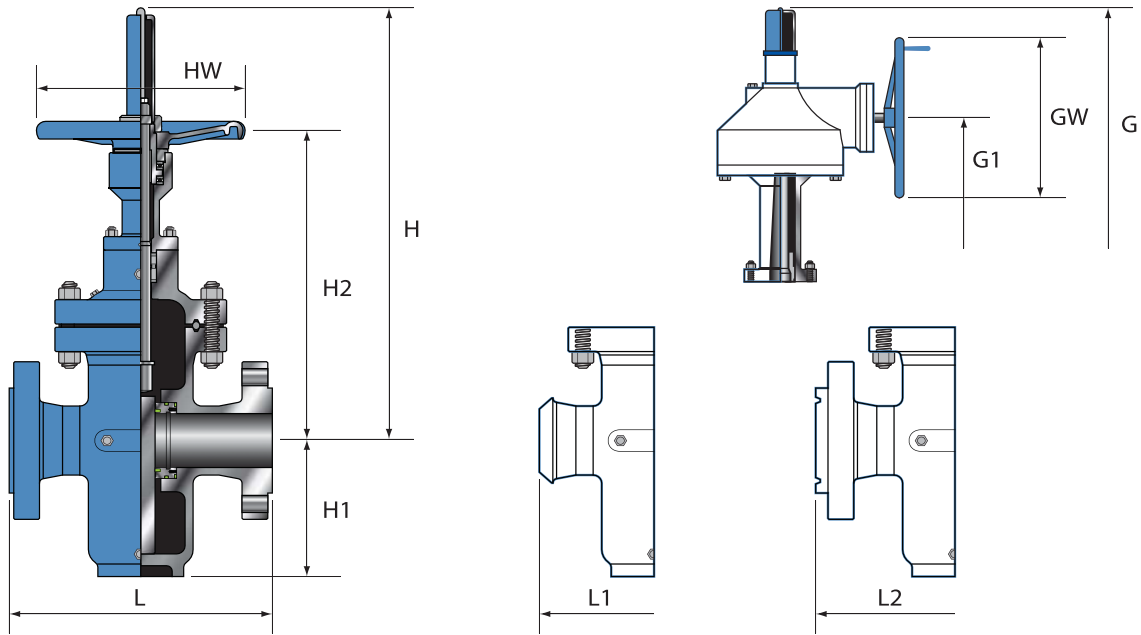

CLASS 150	SIZE		END-TO-END			CENTER-TO-BOTTOM	HANDWHEEL OPERATED				GEAR OPERATED			APPROX. WEIGHTS LBS/KG
			L (RF)	L1 (BW)	L2 (RTJ)	H1	H	H2	HW	G	G1	GW		
IN	2	7	8.5	7.5	4.80	17.72	12.40	9.84	/	/	/	75		
MM	50	178	216	191	122	450	315	250	/	/	/	34		
IN	2.5	7.5	9.5	8	6.06	21.65	16.54	11.81	/	/	/	90		
MM	65	190	241	203	154	550	420	300	/	/	/	41		
IN	3	8	11.12	8.5	6.65	24.02	16.85	11.81	/	/	/	123		
MM	80	203	283	216	169	610	428	300	/	/	/	56		
IN	4	9	12	9.5	7.60	27.56	19.45	11.81	30.31	25.59	12.20	185		
MM	100	229	305	241	193	700	494	300	770	650	310	84		
IN	6	10.5	15.88	11	11.14	35.24	24.61	13.78	37.99	31.50	12.20	313		
MM	150	267	403	279	283	895	625	350	965	800	310	142		
IN	8	11.5	16.5	12	13.86	44.49	30.87	13.78	47.24	37.80	12.20	520		
MM	200	292	419	305	352	1130	784	350	1200	960	310	236		
IN	10	13	18	13.5	17.32	50.79	36.87	15.75	53.54	42.52	12.20	776		
MM	250	330	457	343	440	1290	937	400	1360	1080	310	352		
IN	12	14	19.75	14.5	20.27	58.27	42.52	17.72	61.42	47.24	12.20	992		
MM	300	356	502	368	514	1480	1080	450	1560	1200	310	450		
IN	14	15	22.5	15.5	23.70	64.59	50.51	19.69	68.50	53.15	18.11	1323		
MM	350	381	572	394	602	1660	1283	500	1740	1350	460	600		
IN	16	16	24	16.5	26.69	72.83	55.79	19.69	75.98	59.06	18.11	1623		
MM	400	406	610	419	678	1850	1417	500	1930	1500	460	736		
IN	18	17	26	17.5	30.91	81.89	58.62	23.62	85.04	66.14	18.11	1962		
MM	450	432	660	445	785	2080	1489	600	2160	1680	460	890		
IN	20	18	28	18.5	33.66	90.55	65.83	27.56	95.28	72.83	18.11	2469		
MM	500	457	711	470	855	2300	1672	700	2420	1850	460	1120		
IN	24	20	32	20.5	41.14	105.51	79.21	31.50	110.24	83.46	18.11	4431		
MM	600	508	813	521	1045	2680	2012	800	2800	2120	460	2010		
IN	30	24	36	/	53.15	137.44	100.39	39.37	143.31	110.24	18.11	6438		
MM	750	610	914	/	1350	3491	2550	1000	3640	2800	460	2920		
IN	36	28	40	/	59.45	153.43	112.20	39.37	159.45	121.26	23.62	11839		
MM	900	711	1016	/	1510	3897	2850	1000	4050	3080	600	5370		

*All dimensions are for reference only, please consult sales office prior to automation due to ongoing product development.

Due to the ongoing development of our product line, Global Valve & Controls reserves the right to change the dimensions contained in the leaflet, as required.
Series EXPG/ SBG

JULY 2015 REV. 0

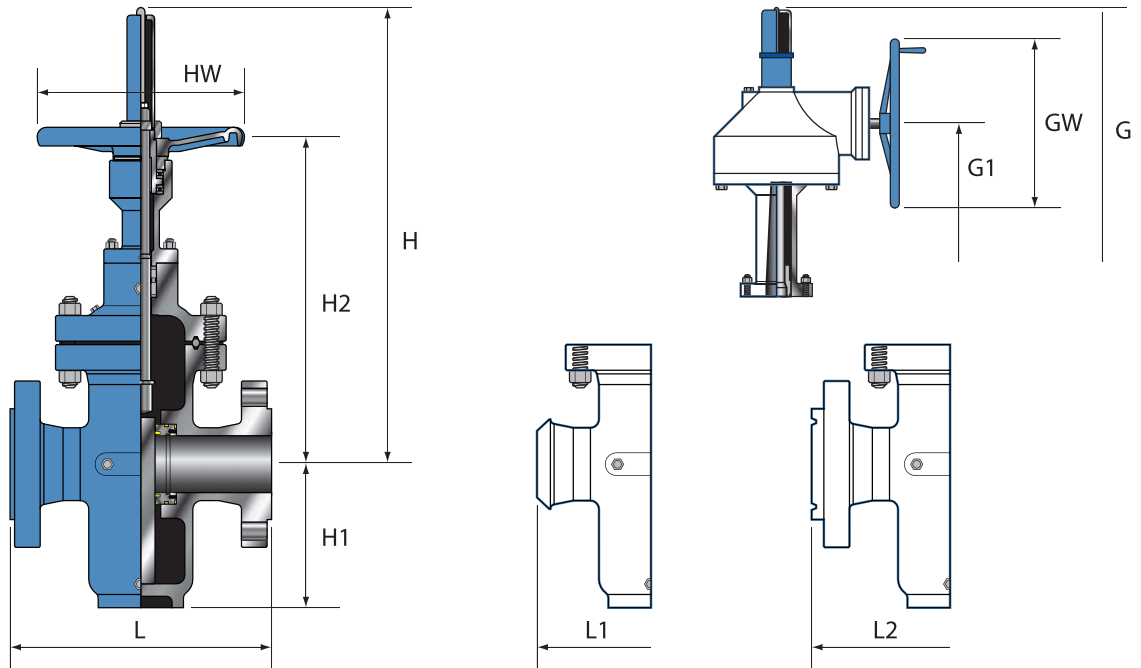

CLASS 300	SIZE		END-TO-END			CENTER-TO-BOTTOM	HANDWHEEL OPERATED			GEAR OPERATED			APPROX. WEIGHTS LBS/KG
			L (RF)	L1 (BW)	L2 (RTJ)	H1	H	H2	HW	G	G1	GW	
IN	2		8.5	8.5	9.12	5.93	18.03	12.80	9.84	/	/	/	119
MM	50		216	216	232	137	458	325	250	/	/	/	54
IN	2.5		9.5	9.5	10.12	6.65	21.85	16.54	11.81	/	/	/	150
MM	65		241	241	257	169	555	420	300	/	/	/	68
IN	3		11.12	11.12	11.74	7.24	24.21	16.93	11.81	/	/	/	187
MM	80		283	283	298	184	615	430	300	/	/	/	85
IN	4		12	12	12.62	8.58	27.95	19.69	11.81	30.31	25.59	12.20	247
MM	100		305	305	321	218	710	500	300	770	650	310	112
IN	6		15.88	15.88	16.5	12.24	34.43	24.61	13.78	37.99	31.50	12.20	529
MM	150		403	403	419	311	900	625	350	965	800	310	240
IN	8		16.5	16.5	17.12	15.04	44.68	31.10	13.78	47.24	37.80	12.20	805
MM	200		419	419	435	382	1135	790	350	1200	960	310	365
IN	10		18	18	18.62	18.74	55.16	40.94	15.75	53.54	42.91	12.20	1102
MM	250		457	457	473	476	1401	1040	400	1360	1090	310	500
IN	12		19.75	19.75	20.37	21.46	62.20	45.28	15.75	61.42	47.24	12.20	1669
MM	300		502	502	518	545	1580	1150	400	1560	1200	310	757
IN	14		30	30	30.62	25.39	/	/	/	68.50	53.15	18.11	2315
MM	350		762	762	778	645	/	/	/	1740	1350	460	1050
IN	16		33	33	33.62	28.66	/	/	/	75.98	60.63	18.11	3263
MM	400		838	838	854	728	/	/	/	1930	1540	460	1480
IN	18		36	36	36.62	31.50	/	/	/	85.04	66.93	18.11	4497
MM	450		914	914	930	800	/	/	/	2160	1700	460	2040
IN	20		39	39	39.75	36.61	/	/	/	95.28	72.83	18.11	5942
MM	500		991	991	1010	930	/	/	/	2420	1850	460	2650
IN	24		45	45	45.88	43.31	/	/	/	110.24	83.46	18.11	9392
MM	600		1143	1143	1165	1100	/	/	/	2800	2120	460	4260
IN	30		55	55	56	55.91	/	/	/	143.31	110.24	18.11	13889
MM	750		1397	1397	1422	1420	/	/	/	3640	2800	460	6300
IN	36		68	68	69.12	59.45	/	/	/	159.45	121.26	23.32	19621
MM	900		1727	1727	1756	1510	/	/	/	4050	3080	600	8900

*All dimensions are for reference only, please consult sales office prior to automation due to ongoing product development.



ENGINEERING DATA

SERIES EXPG / SBG DIMENSIONS

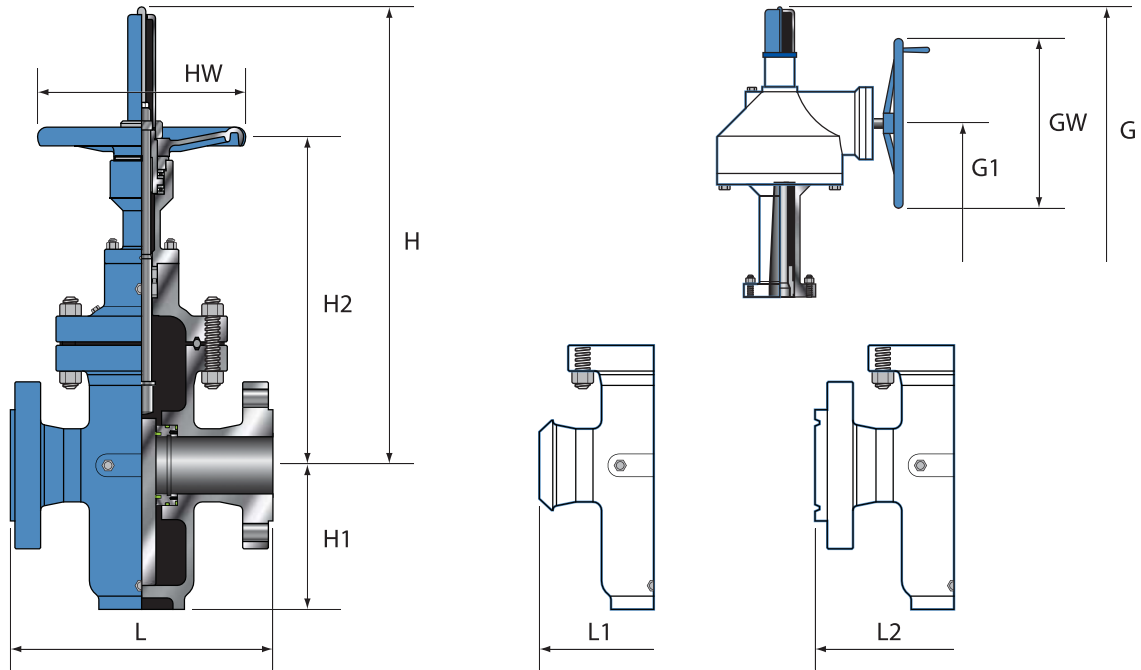

CLASS 600	SIZE		END-TO-END			CENTER-TO-BOTTOM	HANDWHEEL OPERATED			GEAR OPERATED			APPROX. WEIGHTS LBS/KG
			L (RF)	L1 (BW)	L2 (RTJ)	H1	H	H2	HW	G	G1	GW	
IN	2	11.3	11.3	11.62	6.22	18.43	13.19	11.81	19.88	16.93	12.20	146	
MM	50	292	292	295	158	468	335	300	505	430	310	66	
IN	2.5	13	13	13.12	7.48	22.24	16.93	11.81	22.05	18.50	12.20	205	
MM	65	330	330	333	190	565	430	300	560	470	310	93	
IN	3	14	14	14.12	8.86	24.61	17.32	13.78	24.02	20.09	12.20	243	
MM	80	356	356	359	225	625	440	350	610	510	310	110	
IN	4	17	17	17.12	10.14	28.35	20.08	13.78	30.31	25.59	12.20	269	
MM	100	432	432	435	225	720	510	350	689	650	310	156	
IN	6	22	22	22.12	12.99	35.83	24.80	15.75	37.99	31.50	12.20	639	
MM	150	559	559	562	315	910	630	400	941	800	310	296	
IN	8	26	26	26.12	16.14	45.08	31.50	19.69	47.24	37.80	12.20	1411	
MM	200	660	660	664	410	1145	800	500	1200	960	310	640	
IN	10	31	31	31.12	19.29	55.55	41.34	19.69	53.94	42.91	18.11	1984	
MM	250	787	787	791	490	1411	1050	500	1370	1090	460	900	
IN	12	33	33	33.12	22.44	62.60	45.67	23.62	61.42	47.24	18.11	2370	
MM	300	838	838	841	565	1590	1160	600	1620	1200	460	1135	
IN	14	35	35	35.12	25.59	/	/	/	68.50	53.15	18.11	3748	
MM	350	889	889	892	650	/	/	/	1740	1350	460	1700	
IN	16	39	39	39.12	28.94	/	/	/	77.56	60.63	18.11	5533	
MM	400	991	991	994	720	/	/	/	1952	1540	460	2350	
IN	18	43	43	43.12	31.89	/	/	/	88.98	66.93	18.11	6120	
MM	450	1092	1092	1095	810	/	/	/	2260	1700	460	2776	
IN	20	47	47	47.25	35.63	/	/	/	95.28	72.83	18.11	9281	
MM	500	1194	1194	1200	905	/	/	/	2420	1850	460	4210	
IN	24	55	55	55.38	45.67	/	/	/	101.97	79.53	18.11	13250	
MM	600	1397	1397	1407	1160	/	/	/	2590	2020	460	6010	
IN	30	65	65	65.5	51	/	/	/	150	104	24	17439	
MM	750	1651	1651	1664	1290	/	/	/	3821	2654	600	7910	
IN	36	82	82	85.62	60	/	/	/	173	121	24	33510	
MM	900	2083	2083	2175	1530	/	/	/	4400	3070	600	15200	

*All dimensions are for reference only, please consult sales office prior to automation due to ongoing product development.

Due to the ongoing development of our product line, Global Valve & Controls reserves the right to change the dimensions contained in the leaflet, as required.

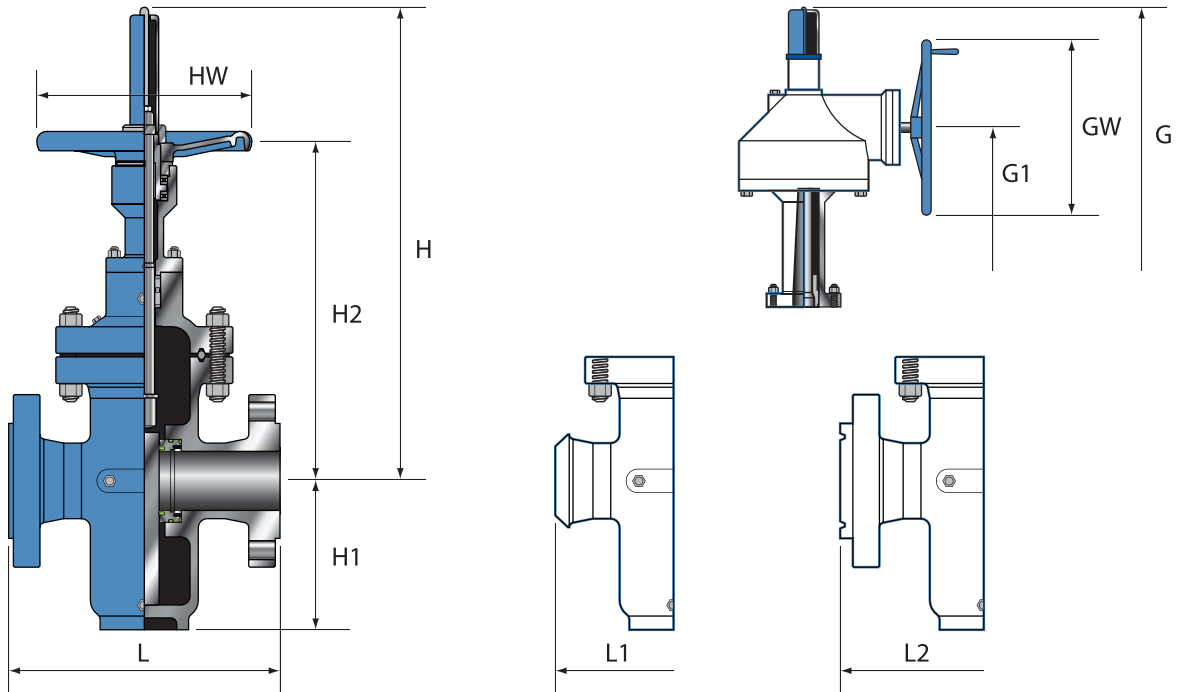

CLASS 900	SIZE		END-TO-END			CENTER-TO-BOTTOM	HANDWHEEL OPERATED			GEAR OPERATED			APPROX. WEIGHTS LBS/KG
			L (RF)	L1 (BW)	L2 (RTJ)	H1	H	H2	HW	G	G1	GW	
IN	2	14.5	14.5	14.62	6.22	18.62	13.19	11.81	20.67	17.72	12.20	227	
MM	50	368	368	371	158	473	335	300	525	450	310	103	
IN	2.5	16.5	16.5	16.62	7.48	22.44	17.13	11.81	23.03	19.29	12.20	298	
MM	65	419	419	422	190	570	435	300	585	490	310	135	
IN	3	15	15	15.12	8.86	24.80	17.52	13.78	25.00	20.87	12.20	375	
MM	80	381	381	384	195	607	445	350	635	530	310	162	
IN	4	18	18	18.12	10.04	28.54	20.28	13.78	31.50	26.77	12.20	463	
MM	100	457	457	460	242	725	515	350	722	680	310	286	
IN	6	24	24	24.12	11.42	36.02	25.20	15.75	39.17	33.95	12.20	1773	
MM	150	610	610	613	290	915	640	400	995	830	310	532	
IN	8	29	29	29.12	18.11	45.28	31.50	19.69	49.21	39.37	18.11	2138	
MM	200	737	737	740	460	1150	800	500	1250	1000	460	970	
IN	10	33	33	33.12	22.05	55.75	41.54	19.69	55.91	44.88	18.11	2877	
MM	250	838	838	841	560	1416	1055	500	1420	1140	460	1305	
IN	12	38	38	38.12	25.98	62.80	45.87	23.62	62.99	48.43	18.11	3967	
MM	300	965	965	968	595	1595	1165	600	1600	1230	460	2000	
IN	14	40.5	40.5	40.88	30.31	/	/	/	70.87	55.12	18.11	5732	
MM	350	1029	1029	1038	770	/	/	/	1800	1400	460	2600	
IN	16	44.5	44.5	44.88	33.07	/	/	/	77.82	63.78	18.11	7318	
MM	400	1130	1130	1140	730	/	/	/	1993	1620	460	3210	
IN	18	48	48	48.5	36.22	/	/	/	88.98	70.28	18.11	8818	
MM	450	1219	1219	1232	920	/	/	/	2260	1785	460	4000	
IN	20	52	52	52.5	39.37	/	/	/	99.21	76.77	18.11	11288	
MM	500	1321	1321	1334	1000	/	/	/	2520	1950	460	5120	
IN	24	61	61	61.75	47.24	/	/	/	104.33	82.68	18.11	20723	
MM	600	1549	1549	1568	1200	/	/	/	2650	2100	460	9400	

*All dimensions are for reference only, please consult sales office prior to automation due to ongoing product development.

Due to the ongoing development of our product line, Global Valve & Controls reserves the right to change the dimensions contained in the leaflet, as required.



ENGINEERING DATA

SERIES EXPG / SBG DIMENSIONS

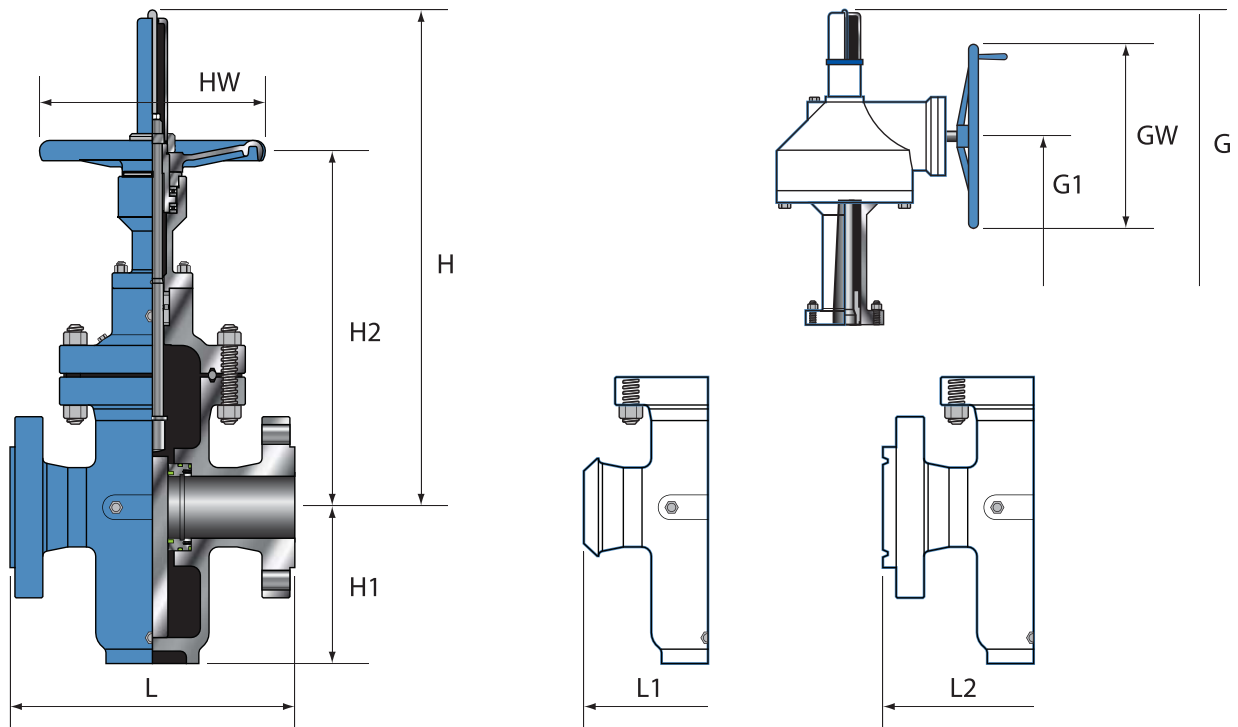

CLASS 1500	SIZE		END-TO-END			CENTER-TO-BOTTOM	HANDWHEEL OPERATED			GEAR OPERATED			APPROX. WEIGHTS LBS/KG
			L (RF)	L1 (BW)	L2 (RTJ)	H1	H	H2	HW	G	G1	GW	
	IN	2	14.5	14.5	14.62	6.50	18.90	13.58	13.78	21.26	14.17	12.20	265
	MM	50	368	368	371	165	480	345	350	540	360	310	120
	IN	2.5	16.5	16.5	16.62	7.99	23.43	17.72	13.78	23.54	19.69	12.20	373
	MM	65	419	419	422	203	595	450	350	598	500	310	169
	IN	3	18.5	18.5	18.62	9.06	25.59	18.50	15.75	25.59	21.46	18.11	573
	MM	80	470	470	473	230	650	470	400	650	545	460	260
	IN	4	21.5	21.5	21.62	10.59	29.13	20.67	17.72	31.89	27.95	18.11	838
	MM	100	546	546	549	269	740	525	450	810	710	460	380
	IN	6	27.75	27.75	28	13.39	38.58	25.59	19.69	42.13	33.07	18.11	2006
	MM	150	705	705	711	340	980	650	500	1070	840	460	910
	IN	8	32.75	32.75	33.13	16.54	/	/	/	53.15	41.34	18.11	3351
	MM	200	832	832	842	420	/	/	/	1350	1050	460	1520
	IN	10	39	39	39.38	20.08	/	/	/	58.26	46.46	18.11	5027
	MM	250	991	991	1000	510	/	/	/	1480	1180	460	2280
	IN	12	44.5	44.5	45.12	23.23	/	/	/	66.14	51.18	18.11	7275
	MM	300	1130	1130	1146	590	/	/	/	1680	1300	460	3300

*All dimensions are for reference only, please consult sales office prior to automation due to ongoing product development.

Due to the ongoing development of our product line, Global Valve & Controls reserves the right to change the dimensions contained in the leaflet, as required.
Series EXPG / SBG

JULY 2015 REV. 0

CV VALUES

The flow co-efficiency (Cv) of a valve is the rate of gallons per minute of water at 60°F through a fully opened valve at a pressure drop of 1 PSI across the valve

SIZE	300	600	900	1500
2	432	384	341	337
3	1155	1109	1072	966
4	2176	1944	1890	1730
6	5300	4577	4383	3622
8	11054	8886	8416	6879
10	18856	14533	14087	11283
12	28980	22729	21025	16843
14	30883	28837	23846	20336
16	42224	39144	33358	27548
18	55740	51368	45004	/
20	70386	64559	56871	/
22	86869	80279	/	/
24	106835	97240	84836	/
26	123222	114905	/	/
28	114355	135267	/	/
30	170229	157401	133706	/
36	245362	224424	/	/

*CV = GPM results in a 1 psi pressure drop

OPTIONAL THERMAL RELIEF MODIFICATIONS

With the expanding gate design, it is possible for the Thermal Expansion to occur within the body cavity while the valve is in the closed position. A Thermal Relief system is available to allow for the body cavity to relieve into the upstream side of the valve.

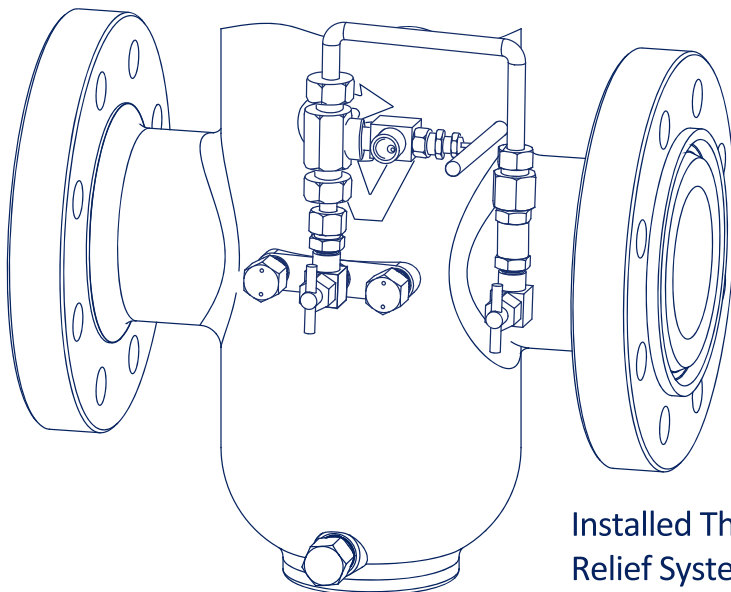

Installed Thermal Relief System

Sample Thermal Relief Configuration

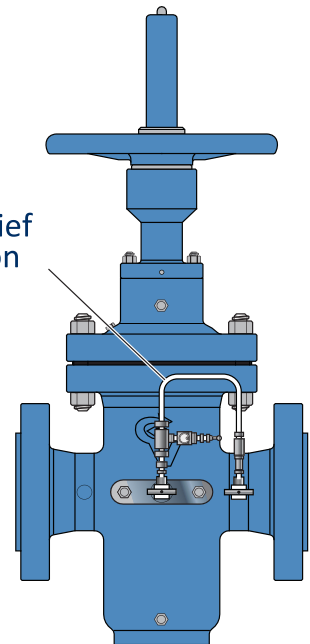

*All dimensions are for reference only, please consult sales office prior to automation due to ongoing product development.

Due to the ongoing development of our product line, Global Valve & Controls reserves the right to change the dimensions contained in the leaflet, as required.



ENGINEERING DATA

SERIES EXPG / SBG PRESSURE TEMPERATURE RATINGS (ASME B16.34)

150	Temp. F	A105	WCB	LF2	WCC	LCB	WC6	LCC	C5	C12	C12A	316	CF8M	F51	F53	
	-20 to 100	285	285	285	290	265	290	290	290	290	290	290	275	275	290	290
	200	260	260	260	260	255	260	260	260	260	260	260	235	235	260	260
	300	230	230	230	230	230	230	230	230	230	230	230	215	215	230	230
	400	200	200	200	200	200	200	200	200	200	200	200	195	195	200	200
	500	170	170	170	170	170	170	170	170	170	170	170	170	170	170	170
	600	140	140	140	140	140	140	140	140	140	140	140	140	140	140	140
	650	125	125	125	125	125	125	125	125	125	125	125	125	125	125	125
	700	110	110	110	110	110	110	110	110	110	110	110	110	110	110	110
	750	95	95	95	95	95	95	95	95	95	95	95	95	95	95	95
	800	80	80	80	80	80	80	80	80	80	80	80	80	80	/	/
	850	65	65	65	65	65	65	65	65	65	65	65	65	65	/	/
	900	50	50	50	50	50	50	50	50	50	50	50	50	50	/	/
	950	35	35	35	35	35	35	35	35	35	35	35	35	35	/	/
	1000	20	20	20	20	20	20	20	20	20	20	20	20	20	/	/
	1050	/	/	/	/	/	/	20	/	20	20	20	20	20	/	/
	1100	/	/	/	/	/	/	20	/	20	20	20	20	20	/	/
	1150	/	/	/	/	/	/	20	/	20	20	20	20	20	/	/
	1200	/	/	/	/	/	/	15	/	15	20	20	20	20	/	/
	1250	/	/	/	/	/	/	/	/	/	/	/	20	20	/	/
1300	/	/	/	/	/	/	/	/	/	/	/	20	20	/	/	
1350	/	/	/	/	/	/	/	/	/	/	/	20	20	/	/	
1400	/	/	/	/	/	/	/	/	/	/	/	20	20	/	/	
1450	/	/	/	/	/	/	/	/	/	/	/	20	20	/	/	
1500	/	/	/	/	/	/	/	/	/	/	/	15	15	/	/	
300	Temp. F	A105	WCB	LF2	WCC	LCB	WC6	LCC	C5	C12	C12A	316	CF8M	F51	F53	
	-20 to 100	740	740	740	750	695	750	750	750	750	750	720	720	750	750	
	200	680	680	680	750	660	750	750	750	750	750	620	620	745	745	
	300	655	655	655	730	640	720	730	730	730	730	560	560	665	665	
	400	635	635	635	705	615	695	705	705	705	705	515	515	615	615	
	500	605	605	605	665	585	665	665	665	665	665	480	480	580	580	
	600	570	570	570	605	550	605	605	605	605	605	450	450	555	555	
	650	550	550	550	590	535	590	590	590	590	590	440	440	545	545	
	700	530	530	530	555	510	570	555	570	570	570	435	435	540	540	
	750	505	505	505	505	475	530	505	530	530	530	425	425	530	530	
	800	410	410	410	410	390	510	410	510	510	510	420	420	/	/	
	850	320	320	320	320	300	485	320	485	485	485	420	420	/	/	
	900	230	230	230	225	200	450	225	375	450	450	415	415	/	/	
	950	135	135	135	135	135	320	135	275	375	385	385	385	385	/	/
	1000	85	85	85	85	85	215	85	200	255	365	365	365	365	/	/
	1050	/	/	/	/	/	145	/	145	170	360	160	160	160	/	/
	1100	/	/	/	/	/	95	/	100	115	300	305	305	305	/	/
	1150	/	/	/	/	/	65	/	60	75	225	235	235	235	/	/
	1200	/	/	/	/	/	40	/	35	50	145	185	185	185	/	/
	1250	/	/	/	/	/	/	/	/	/	/	145	145	145	/	/
1300	/	/	/	/	/	/	/	/	/	/	115	115	115	/	/	
1350	/	/	/	/	/	/	/	/	/	/	95	95	95	/	/	
1400	/	/	/	/	/	/	/	/	/	/	75	75	75	/	/	
1450	/	/	/	/	/	/	/	/	/	/	60	60	60	/	/	
1500	/	/	/	/	/	/	/	/	/	/	40	40	40	/	/	

*All dimensions are for reference only, please consult sales office prior to automation due to ongoing product development.

Due to the ongoing development of our product line, Global Valve & Controls reserves the right to change the dimensions contained in the leaflet, as required.
Series EXPG/ SBG

JULY 2015 REV. 0



ENGINEERING DATA

SERIES EXPG / SBG PRESSURE TEMPERATURE RATINGS (ASME B16.34)

600	Temp. F	A105	WCB	LF2	WCC	LCB	WC6	LCC	C5	C12	C12A	316	CF8M	F51	F53	
	-20 to 100	1480	1480	1480	1500	1395	1500	1500	1500	1500	1500	1500	1440	1440	1500	1500
	200	1360	1360	1360	1500	1320	1500	1500	1500	1500	1500	1500	1240	1240	1490	1490
	300	1310	1310	1310	1455	1275	1445	1455	1455	1455	1455	1455	1120	1120	1335	1335
	400	1265	1265	1265	1405	1230	1385	1405	1410	1410	1410	1410	1025	1025	1230	1230
	500	1205	1205	1205	1330	1175	1330	1330	1330	1330	1330	1330	995	995	1160	1160
	600	1135	1135	1135	1210	1105	1210	1210	1210	1210	1210	1210	900	900	1115	1115
	650	1100	1100	1100	1175	1065	1175	1175	1175	1175	1175	1175	885	885	1095	1095
	700	1060	1060	1060	1110	1025	1135	1110	1135	1135	1135	1135	870	870	1085	1085
	750	1015	1015	1015	1015	955	1065	1015	1065	1065	1065	1065	855	855	1065	1065
	800	825	825	825	825	780	1015	825	1015	1015	1015	1015	845	845	/	/
	850	640	640	640	640	595	975	640	975	975	975	975	835	835	/	/
	900	460	460	460	445	405	900	445	745	900	900	900	830	830	/	/
	950	275	275	275	275	275	640	275	550	755	775	775	775	775	/	/
	1000	170	170	170	170	170	430	170	400	505	725	725	725	725	/	/
	1050	/	/	/	/	/	290	/	290	345	720	720	720	720	/	/
1100	/	/	/	/	/	190	/	200	225	605	610	610	610	/	/	
1150	/	/	/	/	/	130	/	125	150	445	475	475	475	/	/	
1200	/	/	/	/	/	80	/	70	105	290	370	370	370	/	/	
1250	/	/	/	/	/	/	/	/	/	/	295	295	295	/	/	
1300	/	/	/	/	/	/	/	/	/	/	235	235	235	/	/	
1350	/	/	/	/	/	/	/	/	/	/	190	190	190	/	/	
1400	/	/	/	/	/	/	/	/	/	/	150	150	150	/	/	
1450	/	/	/	/	/	/	/	/	/	/	115	115	115	/	/	
1500	/	/	/	/	/	/	/	/	/	/	85	85	85	/	/	
900	Temp. F	A105	WCB	LF2	WCC	LCB	WC6	LCC	C5	C12	C12A	316	CF8M	F51	F53	
	-20 to 100	2220	2220	2220	2250	2090	2250	2250	2250	2250	2250	2160	2160	2250	2250	
	200	2035	2035	2035	2250	1980	2250	2250	2250	2250	2250	1860	1860	2230	2230	
	300	1965	1965	1965	2185	1915	2165	2185	2185	2185	2185	1680	1680	2000	2000	
	400	1900	1900	1900	2110	1845	2080	2110	2115	2115	2115	1540	1540	1845	1845	
	500	1810	1810	1810	1995	1760	1995	1995	1995	1995	1995	1435	1435	1740	1740	
	600	1705	1705	1705	1815	1655	1815	1815	1815	1815	1815	1355	1355	1670	1670	
	650	1650	1650	1650	1765	1600	1765	1765	1765	1765	1765	1325	1325	1640	1640	
	700	1590	1590	1590	1665	1535	1705	1665	1705	1705	1705	1305	1305	1625	1625	
	750	1520	1520	1520	1520	1430	1595	1520	1595	1595	1595	1280	1280	1595	1595	
	800	1235	1235	1235	1235	1175	1525	1235	1525	1525	1525	1265	1265	/	/	
	850	955	955	955	955	895	1460	955	1460	1460	1460	1255	1255	/	/	
	900	690	690	690	670	605	1350	670	1120	1350	1350	1245	1245	/	/	
	950	410	410	410	410	410	955	410	825	1130	1160	1160	1160	1160	/	/
	1000	255	255	255	255	255	650	255	595	760	1090	1090	1090	1090	/	/
	1050	/	/	/	/	/	430	/	430	515	1080	1080	1080	1080	/	/
1100	/	/	/	/	/	290	/	300	340	905	915	915	915	/	/	
1150	/	/	/	/	/	195	/	185	225	670	710	710	710	/	/	
1200	/	/	/	/	/	125	/	105	155	430	555	555	555	/	/	
1250	/	/	/	/	/	/	/	/	/	/	440	440	440	/	/	
1300	/	/	/	/	/	/	/	/	/	/	350	350	350	/	/	
1350	/	/	/	/	/	/	/	/	/	/	290	290	290	/	/	
1400	/	/	/	/	/	/	/	/	/	/	225	225	225	/	/	
1450	/	/	/	/	/	/	/	/	/	/	175	175	175	/	/	
1500	/	/	/	/	/	/	/	/	/	/	125	125	125	/	/	

*All dimensions are for reference only, please consult sales office prior to automation due to ongoing product development.

Due to the ongoing development of our product line, Global Valve & Controls reserves the right to change the dimensions contained in the leaflet, as required.



ENGINEERING DATA

SERIES EXPG / SBG PRESSURE TEMPERATURE RATINGS (ASME B16.34)

1500	Temp. F	A105	WCB	LF2	WCC	LCB	WC6	LCC	C5	C12	C12A	316	CF8M	F51	F53	
	-20 to 100	3705	3705	3705	3750	3480	3750	3750	3750	3750	3750	3750	3600	3600	3750	3750
	200	3395	3395	3395	3750	3300	3750	3750	3750	3750	3750	3750	3095	3095	3720	3720
	300	3270	3270	3270	3640	3190	3610	3640	3640	3640	3640	3640	2795	2795	3335	3335
	400	3170	3170	3170	3520	3075	3465	3520	3530	3530	3530	3530	2570	2570	3070	3070
	500	3015	3015	3015	3325	2930	3325	3325	3325	3325	3325	3325	2390	2390	2905	2905
	600	2840	2840	2840	3025	2755	3025	3025	3025	3025	3025	3025	2255	2255	2785	2785
	650	2745	2745	2745	2940	2665	2940	2940	2940	2940	2940	2940	2210	2210	2735	2735
	700	2665	2665	2665	2775	2560	2840	2775	2840	2840	2840	2840	2170	2170	2710	2710
	750	2535	2535	2535	2535	2385	2660	2535	2660	2660	2660	2660	2135	2135	2660	2660
	800	2055	2055	2055	2055	1955	2540	2055	2540	2540	2540	2540	2110	2110	/	/
	850	1595	1595	1595	1595	1490	2435	1595	2435	2435	2435	2435	2090	2090	/	/
	900	1150	1150	1150	1115	1010	2245	1115	1870	2245	2245	2245	2075	2075	/	/
	950	685	685	685	685	685	1591	685	1370	1885	1930	1930	1930	1930	/	/
	1000	430	430	430	430	430	1080	430	995	1270	1820	1820	1820	1820	/	/
	1050	/	/	/	/	/	720	/	720	855	1800	1800	1800	1800	/	/
	1100	/	/	/	/	/	480	/	495	565	1510	1525	1525	1525	/	/
1150	/	/	/	/	/	325	/	310	375	1115	1185	1185	1185	/	/	
1200	/	/	/	/	/	205	/	170	255	720	925	925	925	/	/	
1250	/	/	/	/	/	/	/	/	/	/	735	735	735	/	/	
1300	/	/	/	/	/	/	/	/	/	/	585	585	585	/	/	
1350	/	/	/	/	/	/	/	/	/	/	480	480	480	/	/	
1400	/	/	/	/	/	/	/	/	/	/	380	380	380	/	/	
1450	/	/	/	/	/	/	/	/	/	/	290	290	290	/	/	
1500	/	/	/	/	/	/	/	/	/	/	205	205	205	/	/	



*All dimensions are for reference only, please consult sales office prior to automation due to ongoing product development.

Due to the ongoing development of our product line, Global Valve & Controls reserves the right to change the dimensions contained in the leaflet, as required.
Series EXPG / SBG



ENGINEERING DATA

SERIES EXPG / SBG FLANGE DIMENSIONS (ANSI B16.5 & B16.47)

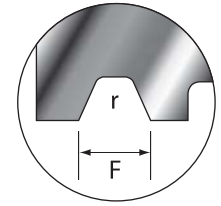
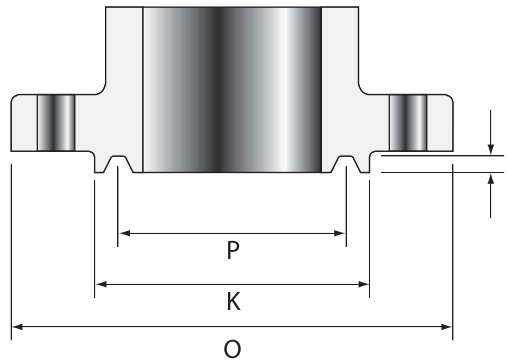
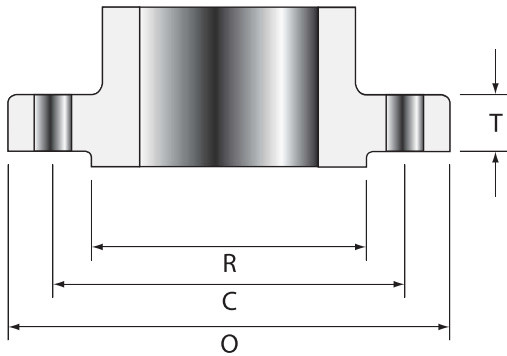

Groove Detail

Class	Size	Flg. Dia.	Flg. Thick.	Raised Face Dia.	Drilling			Face Dia.	Ring Joint					Ring No.
					Bolt Circle Dia.	# of Bolts	Hole Dia.		Pitch Dia.	Grv. Depth	Grv. Width	Btm. Radius		
													O	
150	2	6.00	0.75	3.62	4.75	4	0.75	4.00	3.250	0.250	0.344	0.03	R22	
	2.5	7.00	0.88	4.12	5.50	4	0.75	4.75	4.000	0.250	0.344	0.03	R25	
	3	7.50	0.94	5.00	6.00	4	0.75	5.25	4.500	0.250	0.344	0.03	R29	
	4	9.00	0.94	6.19	7.50	8	0.75	6.75	5.875	0.250	0.344	0.03	R36	
	6	11.00	1.00	8.50	9.50	8	0.88	8.62	7.625	0.250	0.344	0.03	R43	
	8	13.50	1.12	10.62	11.75	8	0.88	10.75	9.750	0.250	0.344	0.03	R48	
	10	16.00	1.19	12.75	14.25	12	1.00	13.00	12.000	0.250	0.344	0.03	R52	
	12	19.00	1.25	15.00	17.00	12	1.00	16.00	15.000	0.250	0.344	0.03	R56	
	14	21.00	1.38	16.25	18.75	12	1.12	16.75	15.625	0.250	0.344	0.03	R59	
	16	23.50	1.44	18.50	21.25	16	1.12	19.00	17.875	0.250	0.344	0.03	R64	
	18	25.00	1.56	21.00	22.75	16	1.25	21.50	20.375	0.250	0.344	0.03	R68	
	20	27.50	1.69	23.00	25.00	20	1.25	23.50	22.000	0.250	0.344	0.03	R72	
	22	29.50	1.81	25.25	27.25	20	1.38	/	/	/	/	/	/	
	24	32.00	1.88	27.25	29.50	20	1.38	28.00	26.500	0.250	0.344	0.03	R76	
	26	34.25	2.69	29.50	31.75	24	1.38	/	29.500	0.500	0.781	0.060	R93	
	28	36.50	2.81	31.50	34.00	28	1.38	/	31.500	0.500	0.781	0.060	R94	
30	38.75	2.94	33.75	36.00	28	1.38	/	33.750	0.500	0.781	0.060	R95		
32	41.75	3.19	36.00	38.50	28	1.62	/	36.000	0.562	0.906	0.060	R96		
34	43.75	3.25	38.00	40.50	32	1.62	/	38.000	0.562	0.906	0.060	R97		
36	46.00	3.56	40.25	42.75	32	1.62	/	40.250	0.562	0.906	0.060	R98		
300	2	6.50	0.88	3.62	5.00	8	0.75	4.25	3.250	0.312	0.469	0.03	R23	
	2.5	7.50	1.00	4.12	5.88	8	0.88	5.00	4.000	0.312	0.469	0.03	R26	
	3	8.25	1.12	5.00	6.62	8	0.88	5.75	4.875	0.312	0.469	0.03	R31	
	4	10.00	1.25	6.19	7.88	8	0.88	6.88	5.875	0.312	0.469	0.03	R37	
	6	12.50	1.44	8.50	10.62	12	0.88	9.50	8.312	0.312	0.469	0.03	R45	
	8	15.00	1.62	10.62	13.00	12	1.00	11.88	10.625	0.312	0.469	0.03	R49	
	10	17.50	1.88	12.75	15.25	16	1.12	14.00	12.750	0.312	0.469	0.03	R53	
	12	20.50	2.00	15.00	17.75	16	1.25	16.25	15.000	0.312	0.469	0.03	R57	
	14	23.00	2.12	16.25	20.25	20	1.25	18.00	16.500	0.312	0.469	0.03	R61	
	16	25.50	2.25	18.50	22.50	20	1.38	20.00	18.500	0.312	0.469	0.03	R65	
	18	28.00	2.38	21.00	24.75	24	1.38	22.62	21.000	0.312	0.469	0.03	R69	
	20	30.50	2.50	23.00	27.00	24	1.38	25.00	23.000	0.375	0.531	0.06	R73	
	22	33.00	2.62	25.25	29.25	24	1.62	27.00	25.000	0.438	0.594	0.06	R81	
	24	36.00	2.75	27.25	32.00	24	1.62	29.50	27.250	0.438	0.656	0.06	R77	
	26	38.25	3.31	29.50	34.50	28	1.75	31.88	29.500	0.500	0.781	0.06	R93	
	28	40.75	3.56	31.50	37.00	28	1.75	33.88	31.500	0.500	0.781	0.06	R94	
30	43.00	3.75	33.75	39.25	28	1.88	36.12	33.750	0.500	0.781	0.06	R95		
32	45.25	3.94	36.00	41.50	28	2.00	38.75	36.000	0.562	0.906	0.06	R96		
34	47.50	4.12	38.00	43.50	28	2.00	40.75	38.000	0.562	0.906	0.06	R97		
36	50.00	4.38	40.25	46.00	32	2.12	43.00	40.250	0.562	0.906	0.06	R98		

*All dimensions are for reference only, please consult sales office prior to automation due to ongoing product development.

Due to the ongoing development of our product line, Global Valve & Controls reserves the right to change the dimensions contained in the leaflet, as required.
Series EXPG/ SBG



ENGINEERING DATA

SERIES EXPG / SBG FLANGE DIMENSIONS (ANSI B16.5 & B16.47)

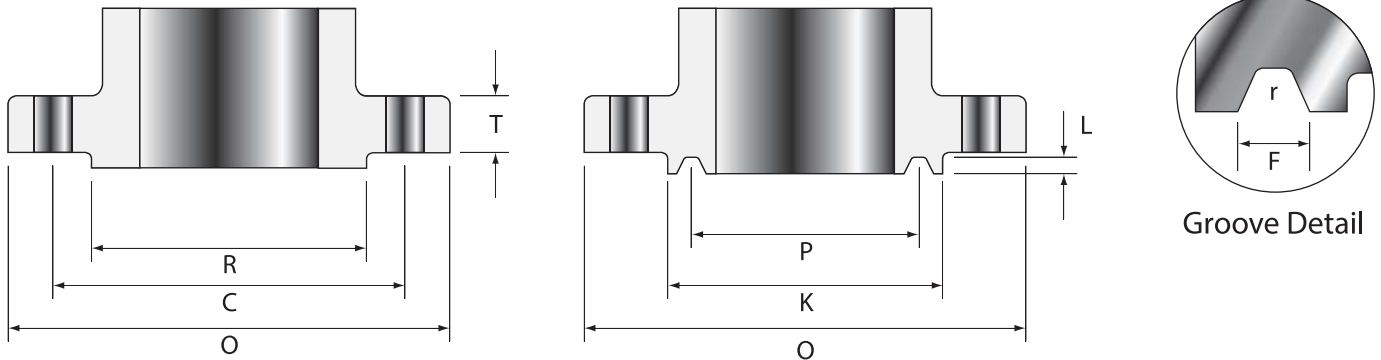

Class	Size	Flg. Dia.	Flg. Thick.	Circle Raise	Drilling			Face Dia.	Ring Joint				Ring No.
					Bolt Circle Dia.	# of Bolts	Hole Dia.		Pitch Dia.	Grv. Depth	Grv. Width	Btm. Radius	
		O	T	R	C			K	P	L	F	r	
600	2	6.50	1.00	3.62	5.00	8	0.75	4.25	3.250	0.312	0.469	0.03	R23
	2.5	7.50	1.12	4.12	5.88	8	0.88	5.00	4.000	0.312	0.469	0.03	R26
	3	8.25	1.25	5.00	6.62	8	0.88	5.75	4.875	0.312	0.469	0.03	R31
	4	10.75	1.50	6.19	8.50	8	1.00	6.88	5.875	0.312	0.469	0.03	R37
	6	14.00	1.88	8.50	11.50	12	1.12	9.50	8.312	0.312	0.469	0.03	R45
	8	16.50	2.19	10.62	13.75	12	1.25	11.88	10.625	0.312	0.469	0.03	R49
	10	20.00	2.50	12.75	17.00	16	1.38	14.00	12.750	0.312	0.469	0.03	R53
	12	22.00	2.62	15.00	19.25	20	1.38	16.25	15.000	0.312	0.469	0.03	R57
	14	23.75	2.75	16.25	20.75	20	1.5	18.00	16.500	0.312	0.469	0.03	R61
	16	27.00	3.00	18.50	23.75	20	1.62	20.00	18.500	0.312	0.469	0.03	R65
	18	29.25	3.25	21.00	25.75	20	1.75	22.62	21.000	0.312	0.469	0.03	R69
	20	32.00	3.50	23.00	28.50	24	1.75	25.00	23.000	0.375	0.531	0.06	R73
22	34.25	3.75	25.25	30.62	24	1.88	27.00	25.000	0.438	0.594	0.06	R81	
24	37.00	4.00	27.25	33.00	24	2.00	29.50	27.250	0.438	0.659	0.06	R77	
900	2	8.5	1.5	3.62	6.5	8	1	4.88	3.75	0.312	0.469	0.03	R24
	2.5	9.62	1.62	4.12	7.50	8	1.12	5.39	4.250	0.312	0.469	0.03	R27
	3	9.50	1.50	5.00	7.50	8	1.00	6.12	4.875	0.312	0.469	0.03	R31
	4	11.50	1.75	6.19	9.25	8	1.25	7.12	5.875	0.312	0.469	0.03	R37
	6	15.50	2.19	8.50	12.50	12	1.25	9.50	8.312	0.312	0.469	0.03	R45
	8	18.50	2.50	10.62	15.50	12	1.50	12.12	10.625	0.312	0.469	0.03	R49
	10	21.50	2.75	12.75	18.50	16	1.50	14.25	12.750	0.312	0.469	0.03	R53
	12	24.00	3.12	15.00	21.00	20	1.50	16.50	15.000	0.312	0.469	0.03	R57
	14	25.25	3.38	16.25	22.00	20	1.62	18.38	16.500	0.438	0.656	0.06	R62
	16	27.75	3.50	18.50	24.25	20	1.75	20.62	18.500	0.438	0.656	0.06	R66
	18	31.00	4.00	21.00	27.00	20	2.00	23.38	21.000	0.500	0.781	0.06	R70
	20	33.75	4.25	23.00	29.50	20	2.12	25.50	23.000	0.500	0.781	0.06	R74
24	41.00	5.50	27.25	35.50	20	2.62	30.38	27.250	0.625	1.062	0.09	R78	
1500	2	8.50	1.50	3.62	6.50	8	1.00	4.88	3.750	0.312	0.469	0.03	R24
	2.5	9.62	1.62	4.12	7.50	8	1.12	5.38	4.250	0.312	0.469	0.03	R27
	3	10.50	1.88	5.00	8.00	8	1.25	6.62	5.375	0.312	0.469	0.03	R35
	4	12.25	2.12	6.19	9.50	8	1.38	7.62	6.375	0.312	0.469	0.03	R39
	6	15.50	3.25	8.50	12.50	12	1.50	9.75	8.312	0.375	0.531	0.06	R46
	8	19.00	3.62	10.62	15.50	12	1.75	12.50	10.625	0.438	0.656	0.06	R50
	10	23.00	4.25	12.75	19.00	12	2.00	14.62	12.750	0.438	0.656	0.06	R54
	12	26.00	4.88	15.00	22.50	16	2.12	17.25	15.000	0.562	0.906	0.06	R58
	14	29.50	5.25	16.25	25.00	16	2.38	19.25	16.500	0.625	1.062	0.09	R63
	16	32.50	5.75	18.50	27.75	16	2.62	21.50	18.500	0.688	1.188	0.09	R67
	18	36.00	6.38	21.00	30.50	16	2.88	24.12	21.000	0.688	1.188	0.09	R71
	20	38.75	7.00	23.00	32.75	16	3.12	26.50	23.000	0.688	1.312	0.09	R75
24	46.00	8.00	27.25	39.00	16	3.62	31.25	27.250	0.812	1.438	0.09	R79	

*All dimensions are for reference only, please consult sales office prior to automation due to ongoing product development.

Due to the ongoing development of our product line, Global Valve & Controls reserves the right to change the dimensions contained in the leaflet, as required.
Series EXPG / SBG

JULY 2015 REV. 0



SERIES SBG

- ◆ Sizes 2 – 36" API 6D Slab Gate Valve
- ◆ Full port, Through Conduit for Passage of Pigs
- ◆ NACE MR0175 Compliant
- ◆ B16.10, B16.5, B16.34 Compliant
- ◆ Live Loaded Stem Packing

Series	Class	Body	Gate	Stem	Seat Inserts	O-Rings	End Connections	Operator	Options	Size
Series SBG Slab Gate Valve	15 – 150	1 - A216 Carbon Steel	1 - A105 + ENP	1 - A105 + ENP	D - Devlon	H - HNBR	RF - Raised Face	HO - Handwheel Operator	X - Special	2"
	30 – 300	WCB								2 1/2"
				3 - A182	3 - A182	Y - Nylon	V - Viton	RTJ - Ring Type Joint		3"
	60 – 600		F316 Stainless Steel	F316 Stainless Steel				GO - Gear Operator		4"
	90 – 900	3 - CF8M 316 Stainless Steel			R - Reinforced Teflon	E-EPDM				6"
							BW - Butt Weld			8"
	51 – 1500		X - Special	3A - A182 F6A				PR - Prepared for Automation		10"
										12"
						X - Special	X - Special			14"
			6 - A216 Carbon Steel WCC		7 - 17 - 4PH Stainless Steel			X - Special		
										18"
										20"
										22"
										24"
										26"
		X - Special		X - Special						30"
										32"
										36"

SBG	60	6	1	7	R	V	RF	GO	-08	
Series	Class	Body	Gate	Stem	Seat Inserts	O-Rings	End Connections	Operator	Options	Size

Description:

Class 600 Raised face, API 6D Full opening Thru Conduit Slab Gate Valve, Full port per API 6D twenty third edition , Double block and bleed design with AISI 1025+Zn sealant injection fittings and drain/vent fittings A216 WCC Body/Bonnet , Gland Flange and Yoke ; A105-ENP Trim, 17-4PH Stem, RPTFE Seat insert, inconel 750 Load springs , PTFE stem packing for low fugitive emissions. Viton O-ring, with secure legs or stands with beveled lockable gear operator.

PLEASE NOTE: There may be some performance variations between the GVC Series SBG and other manufacturer's comparable body designs. To ensure the longevity of performance, please provide specific information relevant to the requirements needed for each application process.

**All dimensions are for reference only, please consult sales office prior to automation due to ongoing product development.*



HOW TO ORDER

SERIES EXPG



SERIES EXPG

- ◆ Sizes 2 – 36" API 6D Expanding Gate Valve
- ◆ Full port, Through Conduit for Passage of Pigs
- ◆ NACE MR0175 Compliant
- ◆ B16.10, B16.5, B16.34 Compliant
- ◆ Live Loaded Stem Packing

Series	Class	Body	Gate	Stem	Seat Inserts	O-Rings	End Connections	Operator	Options	Size
Series EXPG Expanding Gate Valve	30 – 300	1 - A216 Carbon Steel	1 - A105 + ENP	1 - A105 + ENP	D - Devlon	H - HNBR	RF - Raised Face	HO - Handwheel Operator	X - Special	2"
	60 – 600	WCB	3 - A182 F316 Stainless Steel	3 - A182 F316 Stainless Steel	Y - Nylon	V - Viton	RTJ - Ring Type Joint	GO - Gear Operator		2 1/2"
										3"
	90 – 900	3 - CF8M 316 Stainless Steel	X - Special	3A - A182 F6A	X - Special	X - Special	X - Special	PR - Prepared for Automation		4"
										6"
	51 – 1500									8"
										10"
										12"
										14"
										16"
										18"
										20"
22"										
24"										
26"										
30"										
32"										
36"										

EXPG 60 6 1 7 R V RF GO -08

Series	Class	Body	Gate	Stem	Seat Inserts	O-Rings	End Connections	Operator	Options	Size
--------	-------	------	------	------	--------------	---------	-----------------	----------	---------	------

Description:

Class 600 Raised face flanged end, API 6D thru Conduit Expanding Gate Valve with double block and bleed design and tested with F316 stainless steel material for sealant injection fittings for stem and seating area, ASTM -A194- 2HM nuts, with weather proof stem enclosure and stem indicator, with AISI 1025+ZN Gate skirts for Segmented Gate, Full Gate and stopper assembly, AISI 1045 material for lever lock system, ISO 5211 mounting pad with solid pins, lifting ears and leg stand, with 1/2" NPT drilled, tapped and plugged holes for thermal relief system.

PLEASE NOTE: There may be some performance variations between the GVC Series EXPG and other manufacturer's comparable body designs. To ensure the longevity of performance, please provide specific information relevant to the requirements needed for each application process.



8535 Jackrabbit Rd., Ste i
Houston, TX 77095
866.965.8GVC (482)
281.463.1474 office
281.463.7735 fax
www.GVCINTL.com

**All dimensions are for reference only, please consult sales office prior to automation due to ongoing product development.*

Due to the ongoing development of our product line, Global Valve & Controls reserves the right to change the dimensions contained in the leaflet, as required.